

Auto-Retractable Tonneau Cover Installation Guide

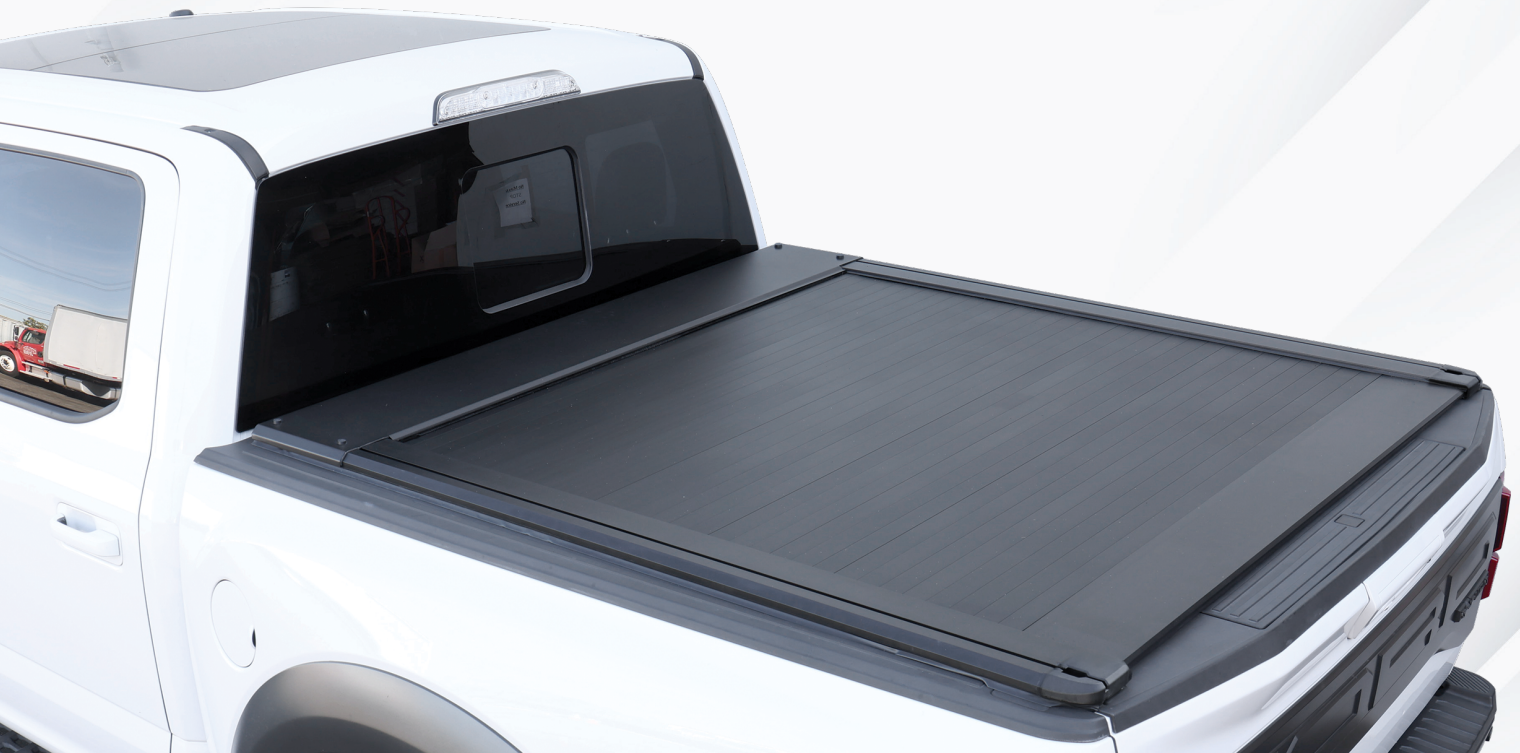


Table of Contents

*Some models require specific steps and parts. Please check below. If your model is listed, follow the instructions on that page.

1-7

5FT / 5.5FT

Fit: F150, Ram, Ranger, Colorado, Titan, Tundra, Canyon, Sierra 1500 & Silverado 1500



▶ Watch Full Video Here
<https://bit.ly/3E6jYIC>

17-25

6FT / 6.5FT / 6.8FT

Fit: F-150/F-250/F-350, Tundra, Ram 1500/2500/3500, Sierra 1500/2500/3500, Silverado 1500/2500/3500



▶ Watch Full Video Here
<https://bit.ly/3E6jYIC>

8-16

With deck rail

Fit: Tacoma and Tundra



▶ Watch Full Video Here
<https://bit.ly/3vUsikL>



jcwinauto@gmail.com
ebay@syneticusa.com



<https://jcwinauto.com/>
<http://syneticusa.com/>



facebook.com/jcwinauto
facebook.com/SyneticUSA



We highly recommend watching the video prior to starting the installation. Please

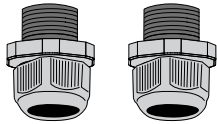
scan this QR code

to see our full installation video of this product first! Before installing, please check to make sure the retraction mechanism works. If the triangular piece does not retract on either side of the cover, stop at once and contact us for assistance first.

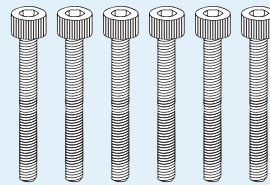


FIG 3

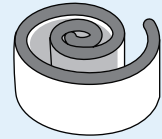
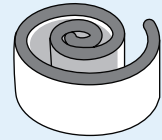
Drain tubes



5in screws *SILVERADO ONLY*

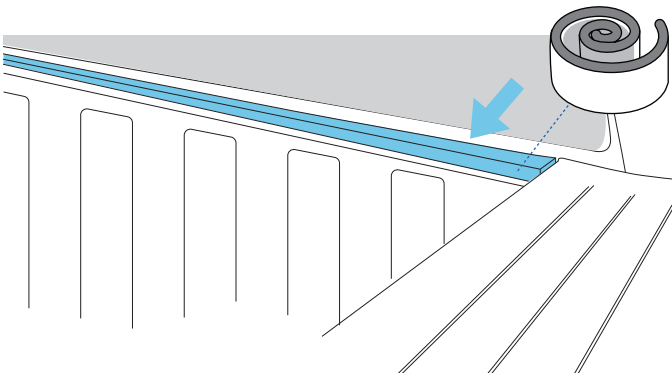


Foam rolls



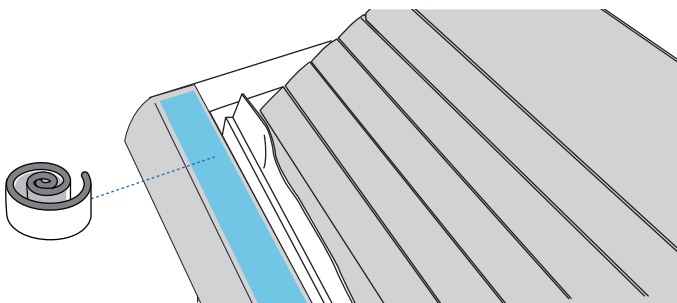
1 Apply foam (Part 1)

Apply the thinner foam roll on the front of the truck bed.



2 Apply foam (Part 2)

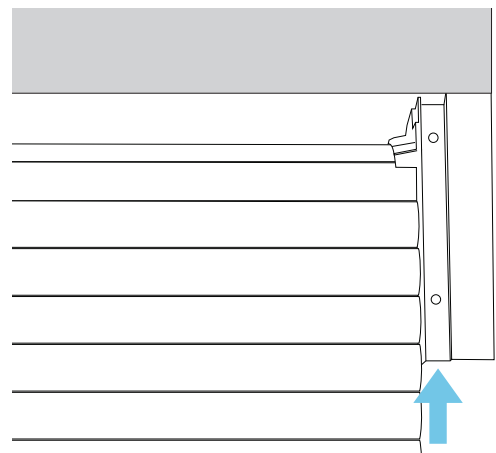
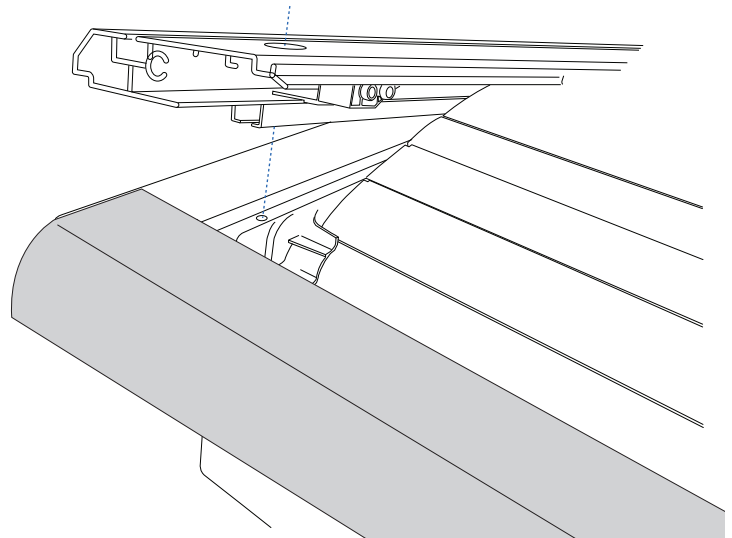
Start assembling on a leveled surface using the foam blocks from the packaging to help keeping the rails raised. Apply the wider foam roll on the front of the cover, across the white bar as shown. Both foam rolls are applied to ensure full waterproof function of the item.



3 Install rails

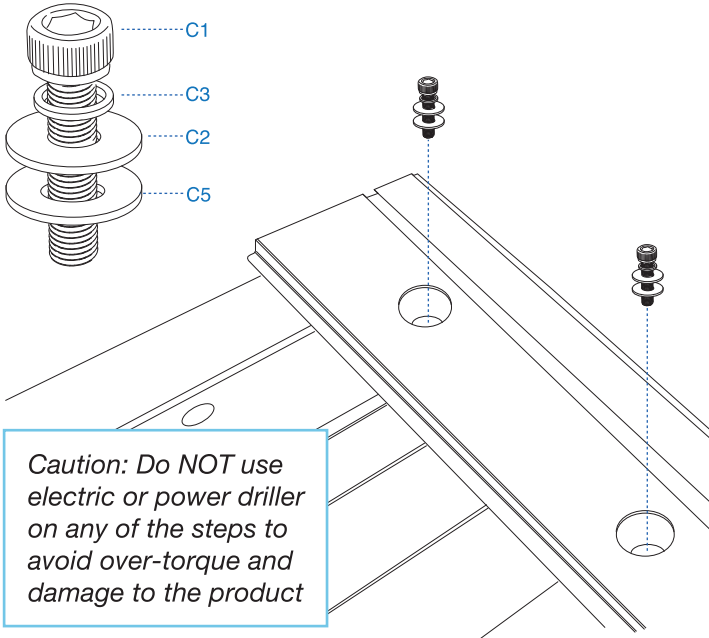
Install the rails onto the cover.

Note: The sides of the cover, next to the white part, there is small black strip that is supposed to slide and clip right into a tunnel under the rail, see photo.



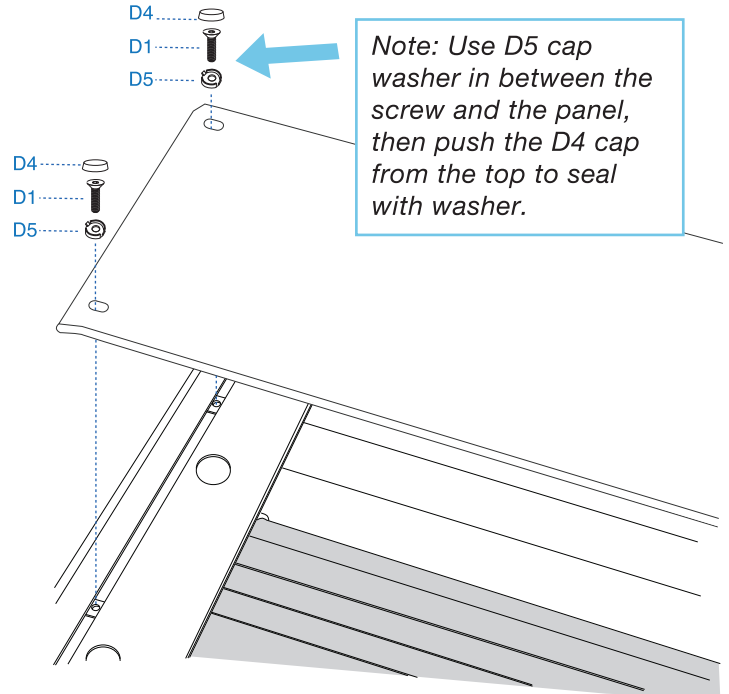
4A Install rails

With the rails in place and the cover slid into the rail channel, attach the rails with the four C1 mounting screws.



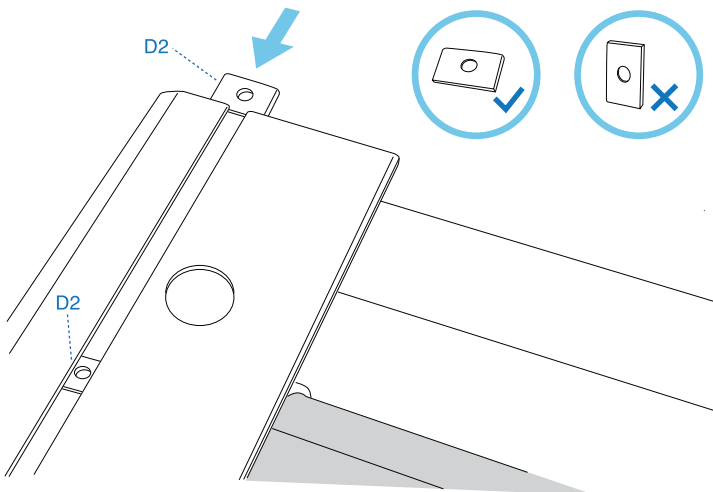
4c Lock panel (Part 2)

Place the panel on top of the cover, then adjust the nuts in the groove to align with holes on the panel. Finally, use wrench on the D1 screws to fix the panel onto the cover assembly.



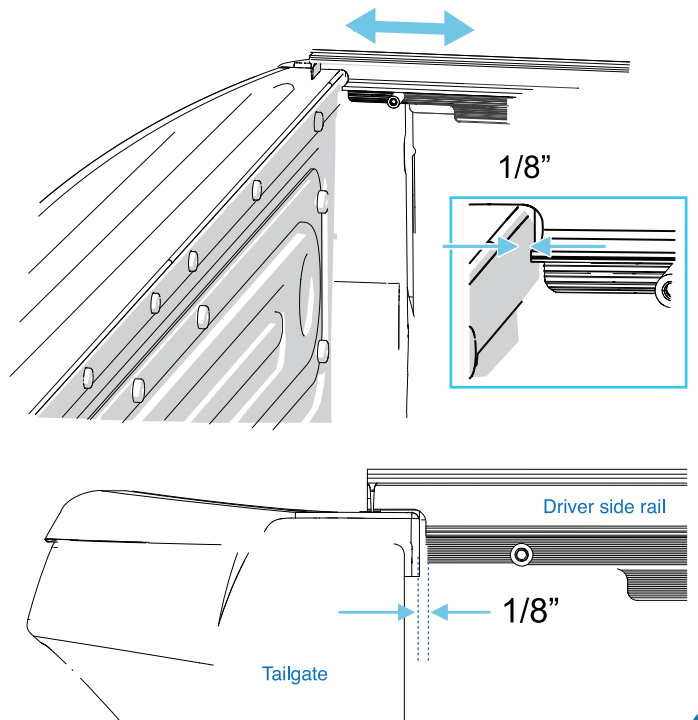
4B Lock panel (Part 1)

Lock the panel onto the cover. First, slide two D2 screw locks into the groove on the rail, make sure the wider side goes in, not the shorter side. If done correctly, the locks should not move loosely once inserted inside. Do this for the other rail. The tip of the wrench can be used here to help sliding the lock in or out.



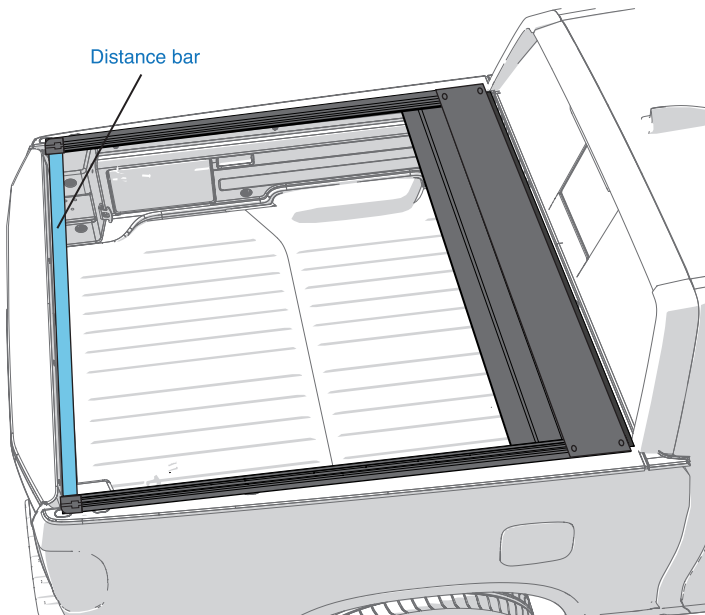
5A Adjust rails (Part 1)

Lift the cover and set down on the truck bed, push it forward, all the way to the front of the bed underneath the cab window, the front of the cover should sit above the foam you applied. Move the rails to achieve the 1/8" gap. Make certain the rails do not move after measuring.



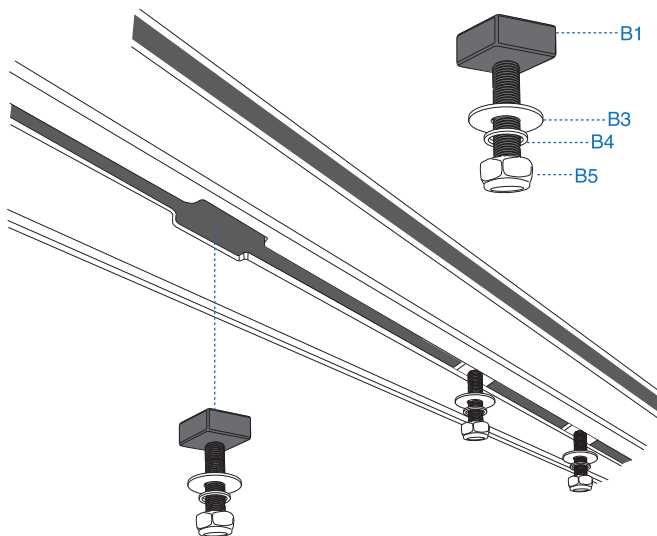
5B Adjust rails (Part 2)

Install the distance bar to check rail position. Insert the distance bar as below, make sure the distance bar reach the end cab of rail.



6 Clamp prep work

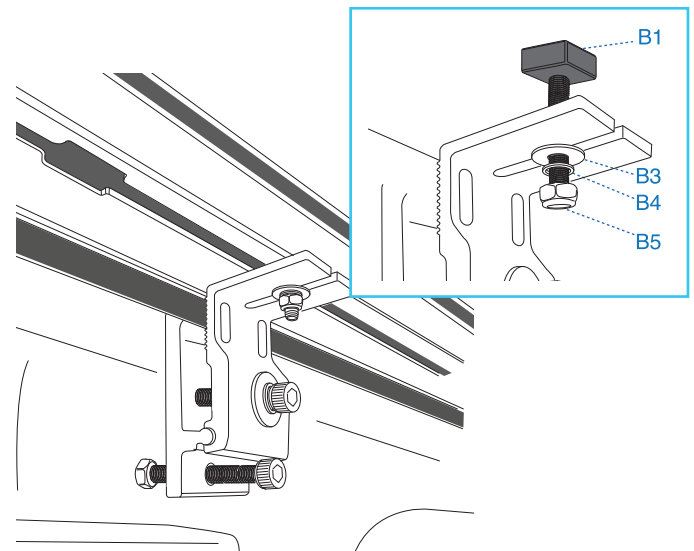
Now check under the rail for another groove and look for an opening on the groove. Insert 3 of the assembled bolts into the opening one at a time, and slide them towards the front, middle, and the back of the rail. Do this for the other rail. Clamps will go on these places.



7 Install clamps

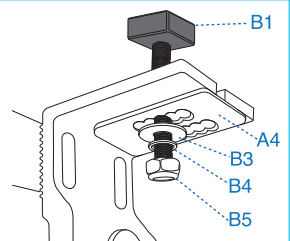
First note the slit on each of the clamps, insert clamps to the bolts. There are 6 clamps, one for each bolt. Make sure the slit sits between the B1 t-slot nut and the B3 washer of the bolt.

Note: Push clamp against the side of the rail cap while using 10mm wrench to tighten B5 nuts.

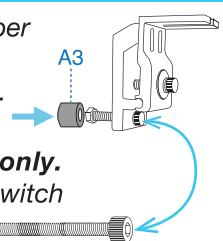


Make sure the clamps are properly clamped onto the truck bed under the rail and the rails are pushed down before tightening the bolt and the clamp. ***IMPORTANT*** Rails must be pushed down while tightening the clamps to ensure the complete seal at the tailgate.

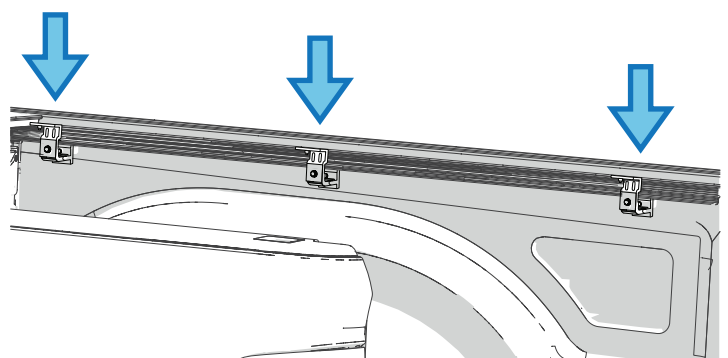
Optional: Add A4 plates to the two clamps closest to the tailgate, one on each rail. Caution! Holes on both plates must match. If one clamp uses the 2nd hole the other clamp must do too.



Optional: Add A3 rubber cap to the screw that touches the truck bed.



Note: For Silverado only. If screw is too short, switch it to the 5in screw.

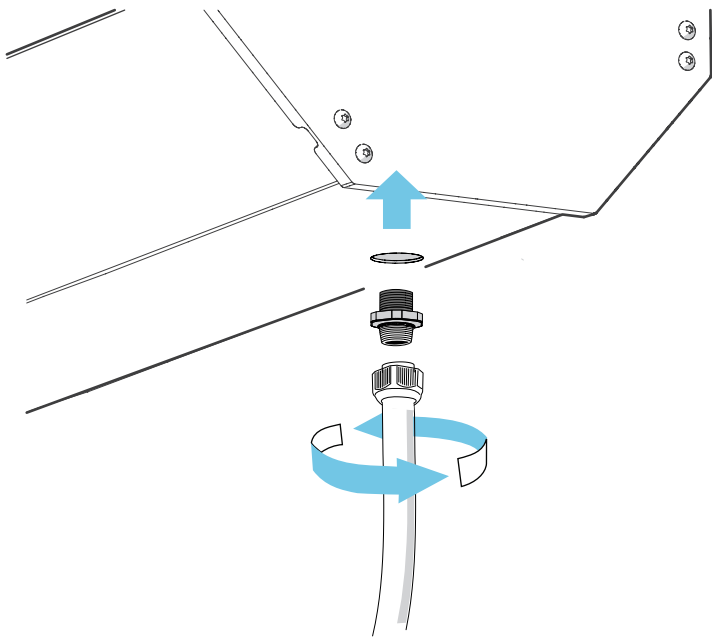


8 Install drainage tubes

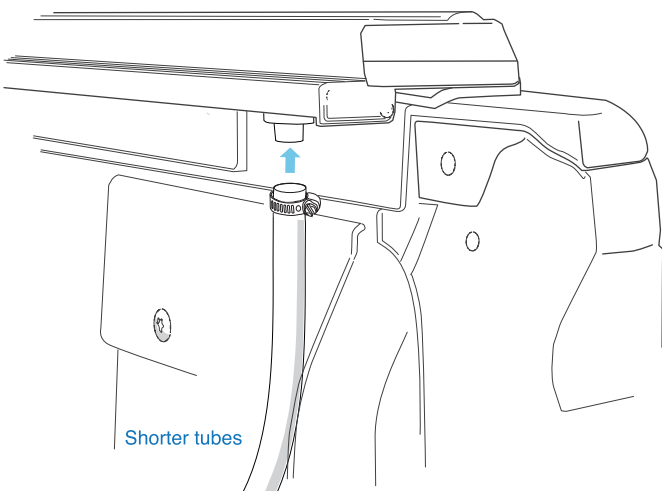
Lock two tubes under the canister using the black connectors. Hook the other two tubes onto the end of the rails, tightened. Insert the rest of the tubes to the holes on the truck bed.

Note: Here that not all trucks have predrilled holes, you may need to drill small holes just big enough to plug tubes in that leads out from the bed.

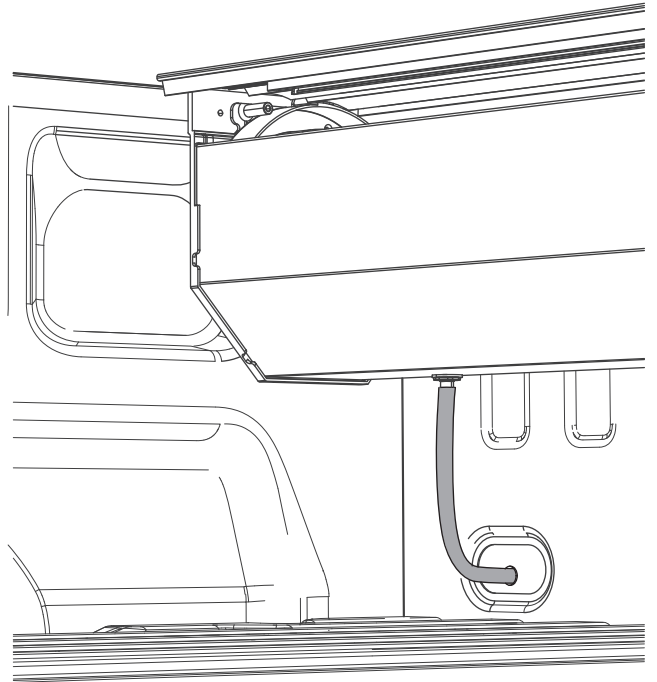
Drain tube for canister



Drain tube for rail



Generally the drain tubes will be routed out through a hole drilled in the factory bed plug. Other a suitable existing hole must be utilized. Or a new hole can be drilled, taking great caution to be aware of lines and anything behind where the hole is drilled.

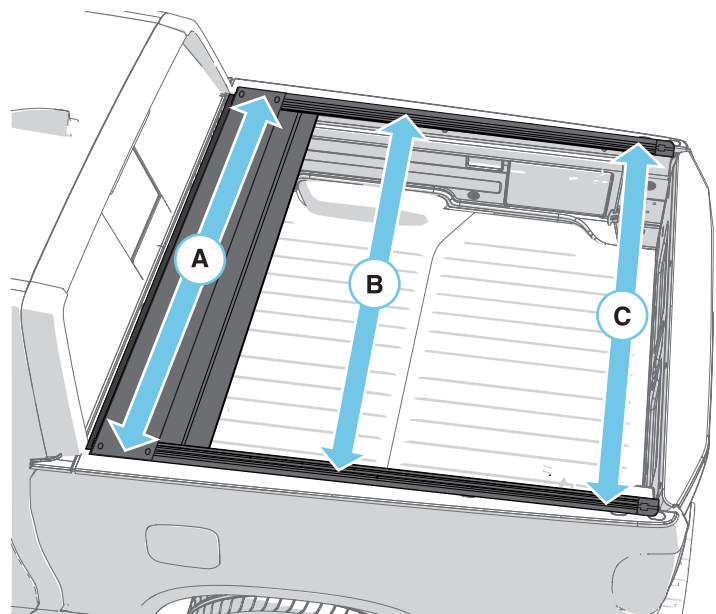


9 Final Check

Make sure A, B, and C are equidistant. Measure the distance between the rails at these three locations. Make sure the distance stays the same ($\pm 1/16"$ as at point A) and parallel.

Note: Rails distance adjustment shown on STEP 5A

Note: Remove distance bar



For safety purpose

- Never stand, sit or ride on the cover or allow others to do so.
- Do not allow people or animals to occupy bed with the cover closed.
- Keep cover closed when going through auto car wash.

Additional clarification and information

Here are some common questions and concerns buyers often have on the product design, we will address each one of them in the points below, to reassure you the quality of our product

- *Lock and Unlock*

See next page

- *Adjust rolling speed*

Check and change the tightness of the screw on the right side of the canister, rotate the screw clockwise for faster and counter clockwise for slower rolling. Do 30 revolutions at a time, if the cover is still rolling too slow or too fast after 30 revolutions, do another 30 revolutions to get a more visible result. (Image 1)

- Cover may be rolling fast now since some customers suggest rolling is too slow. This is completely normal not an issue and the speed is also adjustable as stated. Additionally, after long use the spring inside will naturally slow down the rolling speed as well.

- *Use the strap*

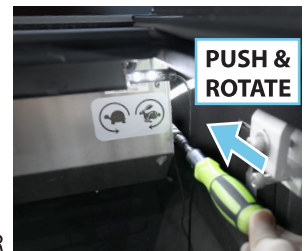
When the cover is close to fully retracted, hold the pull strap and allow it to slip through your fingers to prevent a heavy slam on the canister, this helps keeping the product in working condition for a longer period of time.



Image 1



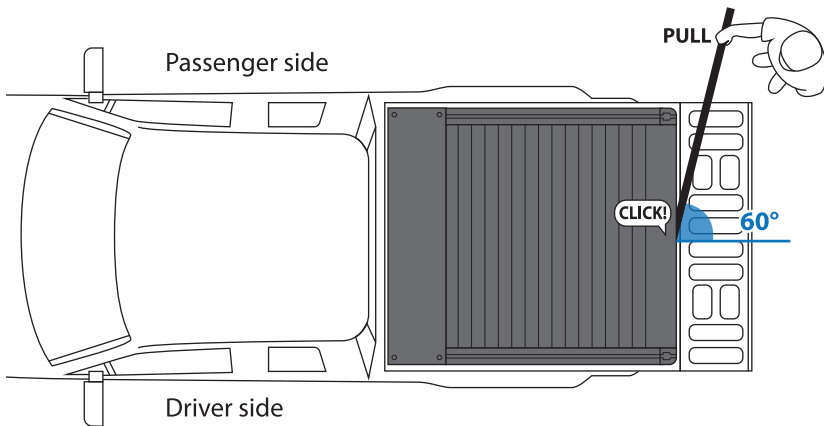
5/16"
NUT DRIVER



Warranty information

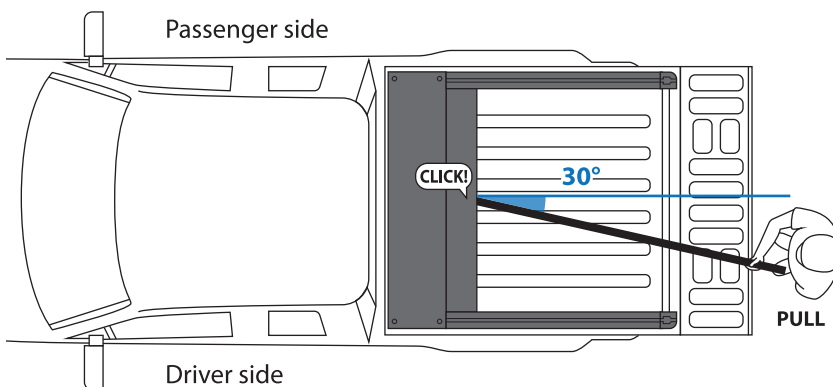
We take responsibility over our product, please contact us for any kind of concern or inquiry regarding your purchase. There is a **one-year warranty** on this tonneau cover. To contact our service team, find us at <https://jcwinauto.com> or send an email to jcwinauto@gmail.com, we normally respond within 24 hours during business hours, closed on weekend.

HOW TO OPEN, CLOSE AND STOP



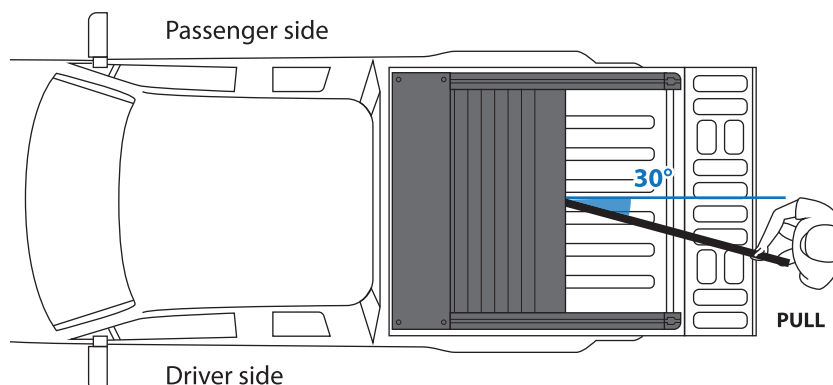
OPEN

Let the cover roll slowly



CLOSE

Pull the cover towards tailgate



STOP MIDWAY

When closing, pull the cover, then slowly release the strap

OR

When opening, move to the driver side rear after the cover starts rolling

Auto-Retractable Tonneau Cover Installation Guide

For Tacoma and Tundra
(with deck rail)



jcwinauto@gmail.com
ebay@syneticusa.com



<https://jcwinauto.com/>
<http://syneticusa.com/>



facebook.com/jcwinauto
facebook.com/SyneticUSA

“



We highly recommend watching the video prior to starting the installation. Please

scan this QR code

to see our full installation video of this product first! Before installing, please check to make sure the retraction mechanism works. If the triangular piece does not retract on either side of the cover, stop at once and contact us for assistance first.

”



SCAN ME

See full installation video [here](#). Before installing, please check to make sure the retraction mechanism works. If the triangular piece does not retract on either side of the cover, stop at once and contact us for assistance first.

Components

Main cover x1	B1	T-slot screws x6	C4	wrench x1
Rails x2	B3	washer(L) x6	C5	plastic washer x4
Cover panel x1	B4	washer(S) x6	D1	screw x4
Foam roll x2	B5	10mm hex nut x6	D2	T-slot nut x4
Tube x4	B6	wrench x1	D3	wrench x1
Tube connector x4	C1	screw x4	D4	screw cap x4
A clamp x6	C2	washer(L) x4	D5	cap washer x4
E lubricating oil	C3	washer(S) x4	A3	rubber cap x6



CAUTION: Over torquing hardware may damage components.

Parts Diagram

FIG 1

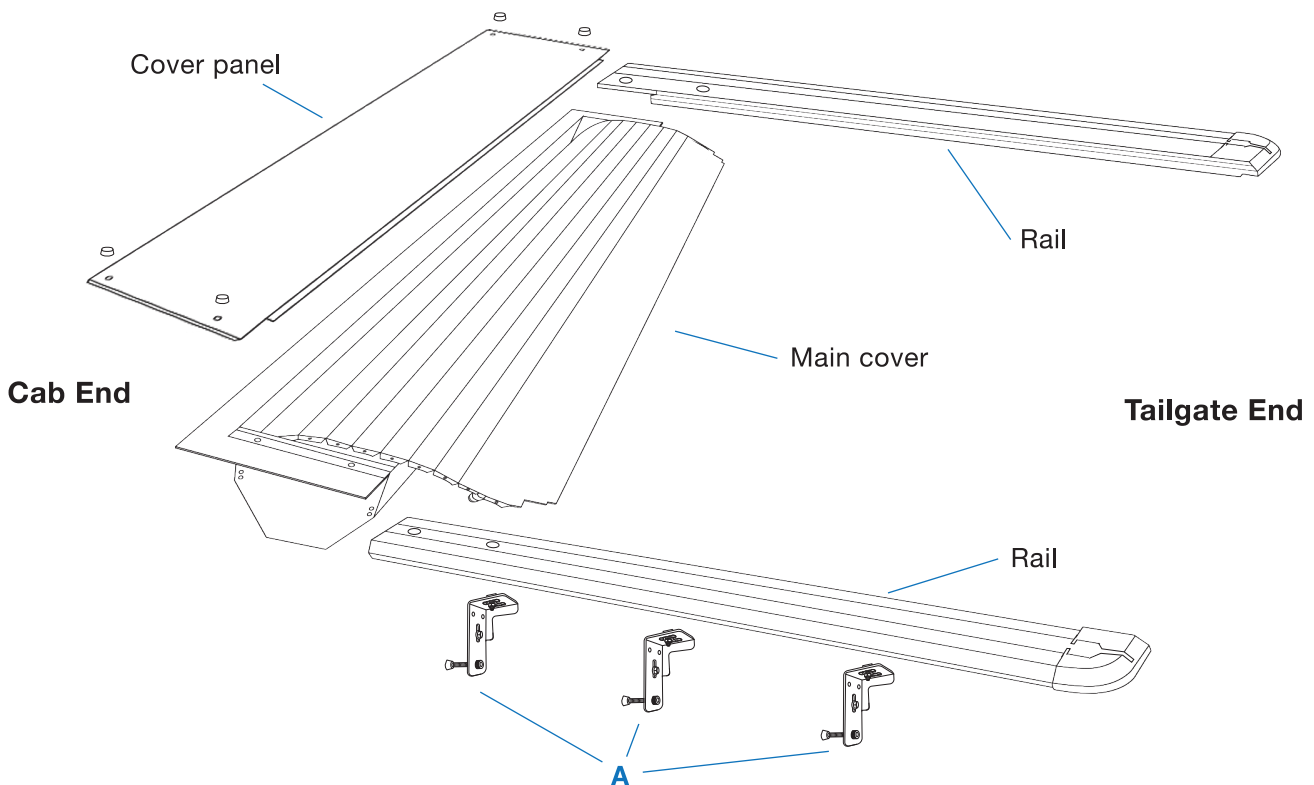


FIG 2

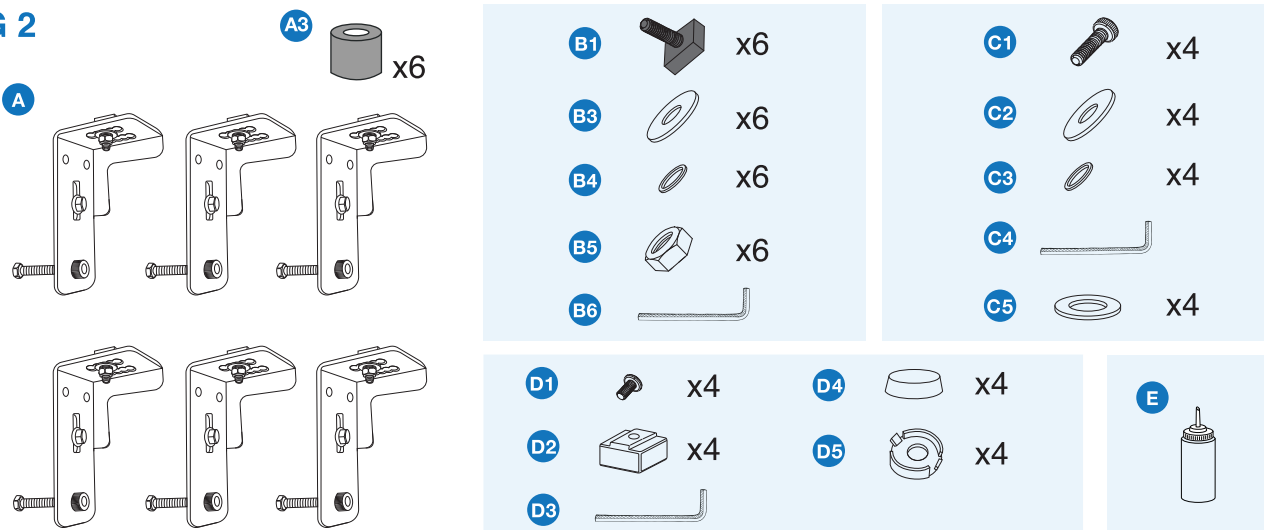
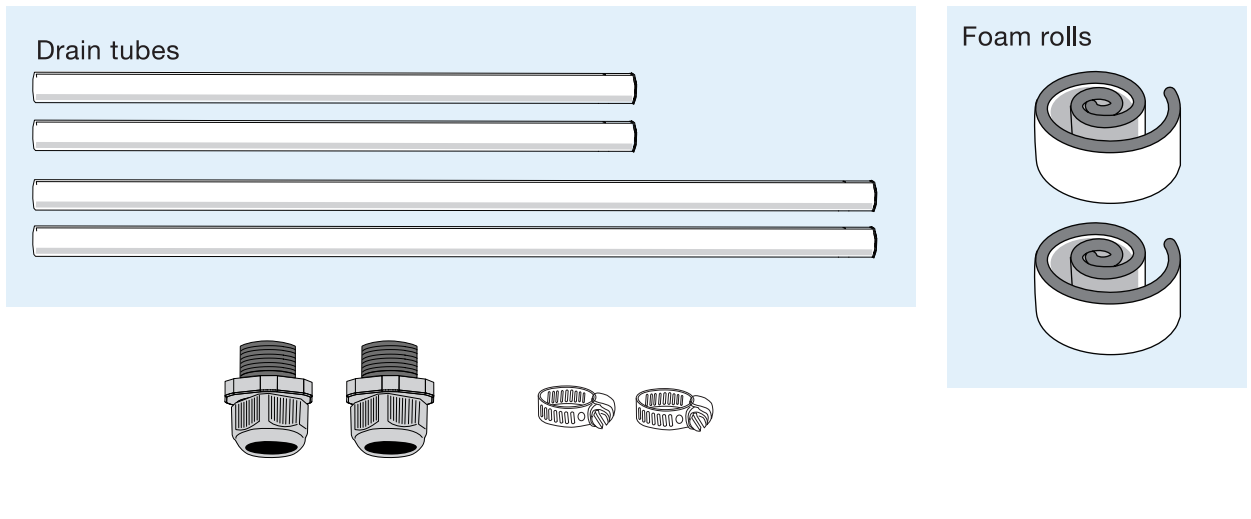
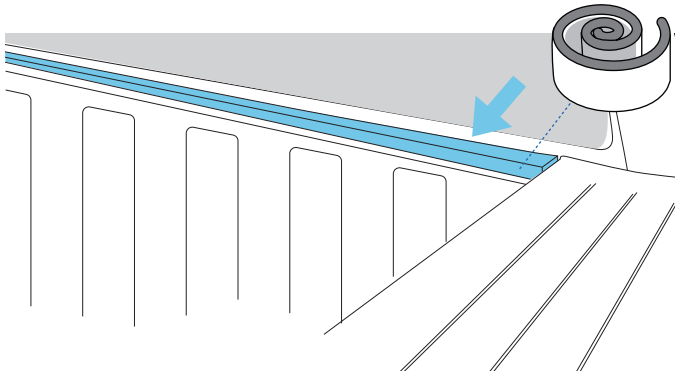


FIG 3



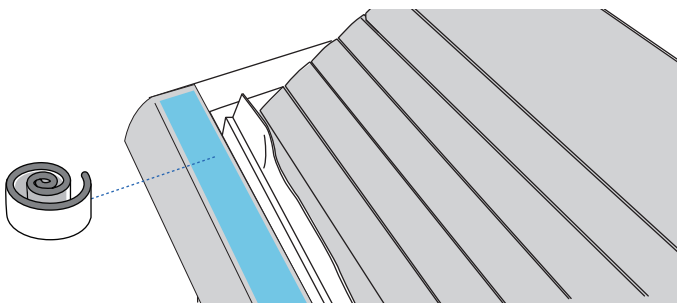
1 Apply foam (Part 1)

Apply the thinner foam roll on the front of the truck bed.



2 Apply foam (Part 2)

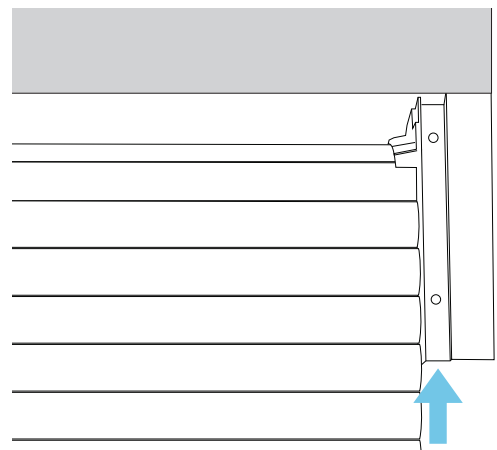
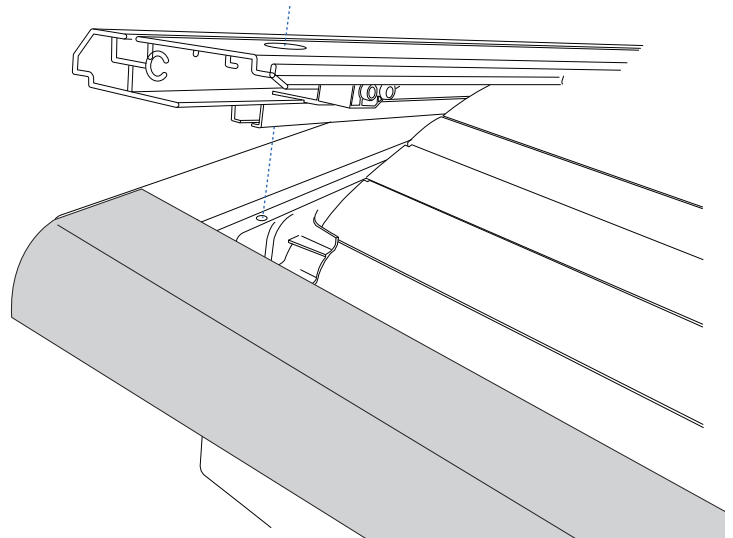
Start assembling on a leveled surface using the foam blocks from the packaging to help keeping the rails raised. Apply the wider foam roll on the front of the cover, across the white bar as shown. Both foam rolls are applied to ensure full waterproof function of the item.



3 Install rails

Install the rails onto the cover.

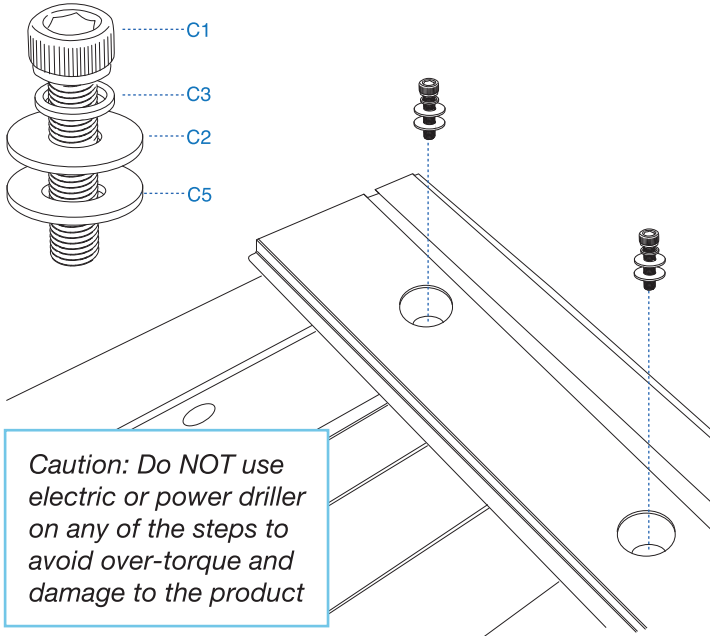
Note: The sides of the cover, next to the white part, there is small black strip that is supposed to slide and clip right into a tunnel under the rail, see photo.



4A

Install rails

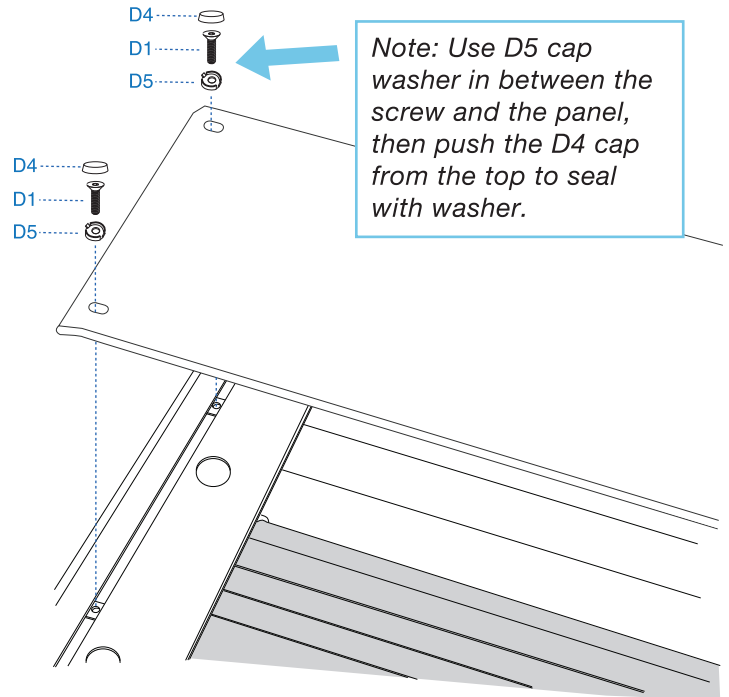
With the rails in place and the cover slid into the rail channel, attach the rails with the four C1 mounting screws.



4C

Lock panel (Part 2)

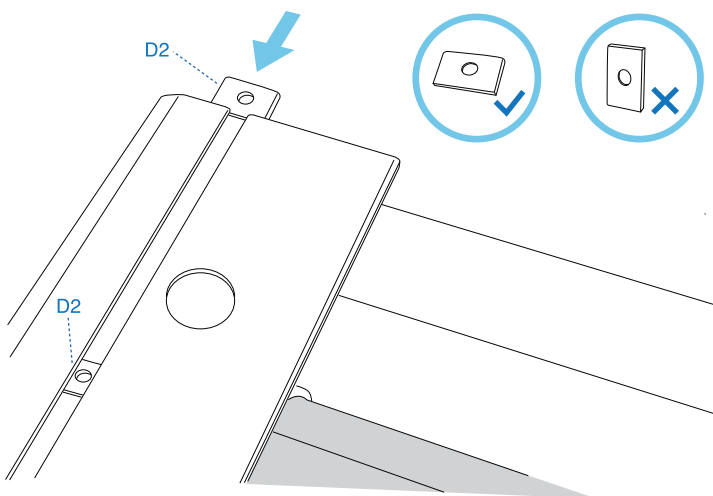
Place the panel on top of the cover, then adjust the nuts in the groove to align with holes on the panel. Finally, use wrench on the D1 screws to fix the panel onto the cover assembly.



4B

Lock panel (Part 1)

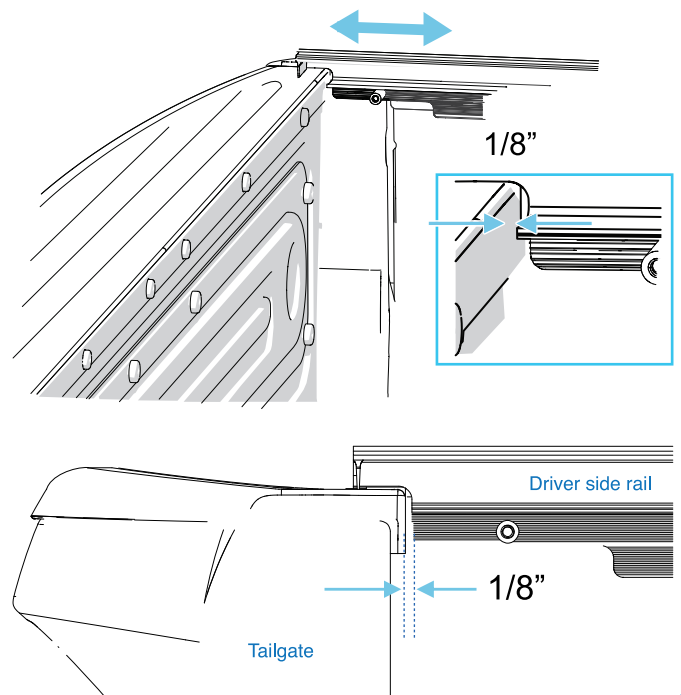
Lock the panel onto the cover. First, slide two D2 t-slot nuts into the groove on the rail, make sure the wider side goes in, not the shorter side. If done correctly, the nuts should not move loosely once inserted inside. Do this for the other rail. The tip of the wrench can be used here to help sliding the lock in or out.



5A

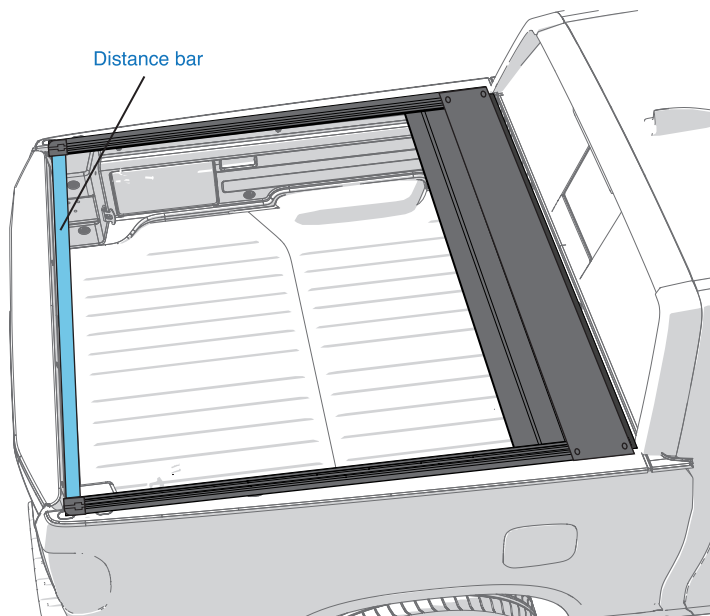
Adjust rails (Part 1)

Lift the cover and set down on the truck bed, push it forward, all the way to the front of the bed underneath the cab window, the front of the cover should sit above the foam you applied. Move the rails to achieve the 1/8" gap. Make certain the rails do not move after measuring.



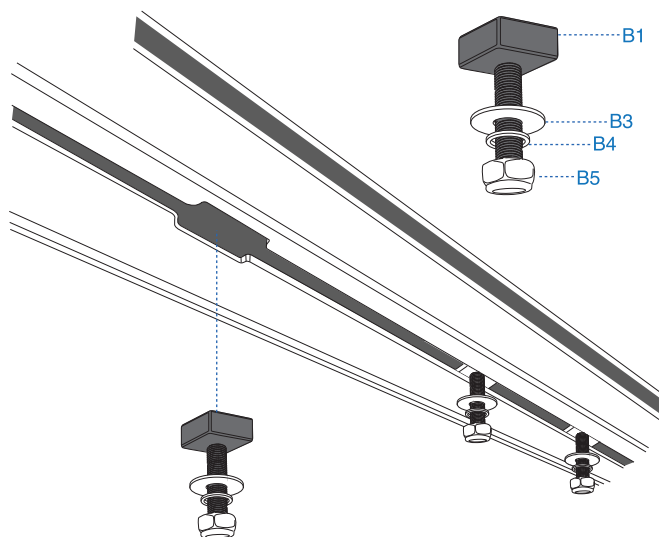
5B Adjust rails (Part 2)

Install the distance bar to check rail position. Insert the distance bar as below, make sure the distance bar reach the end cab of rail.



6 Clamp prep work

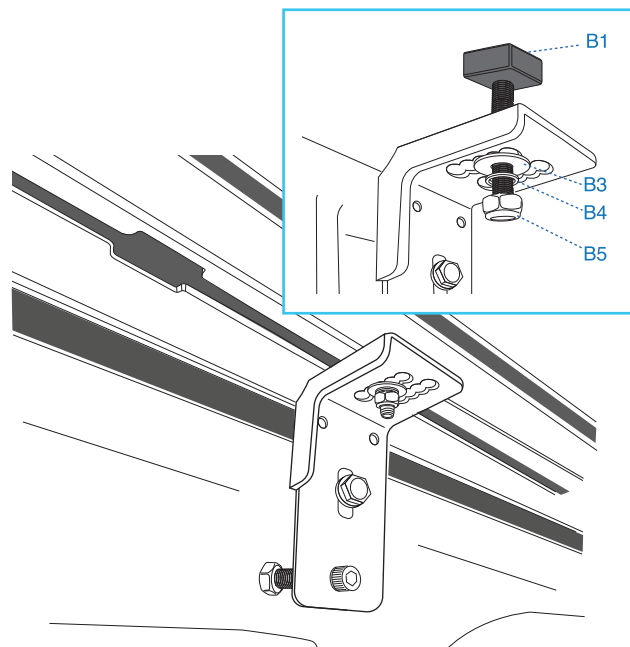
Now check under the rail for another groove and look for an opening on the groove. Insert 3 of the assembled bolts into the opening one at a time, and slide them towards the front, middle, and the back of the rail. Do this for the other rail. Clamps will go on these places.



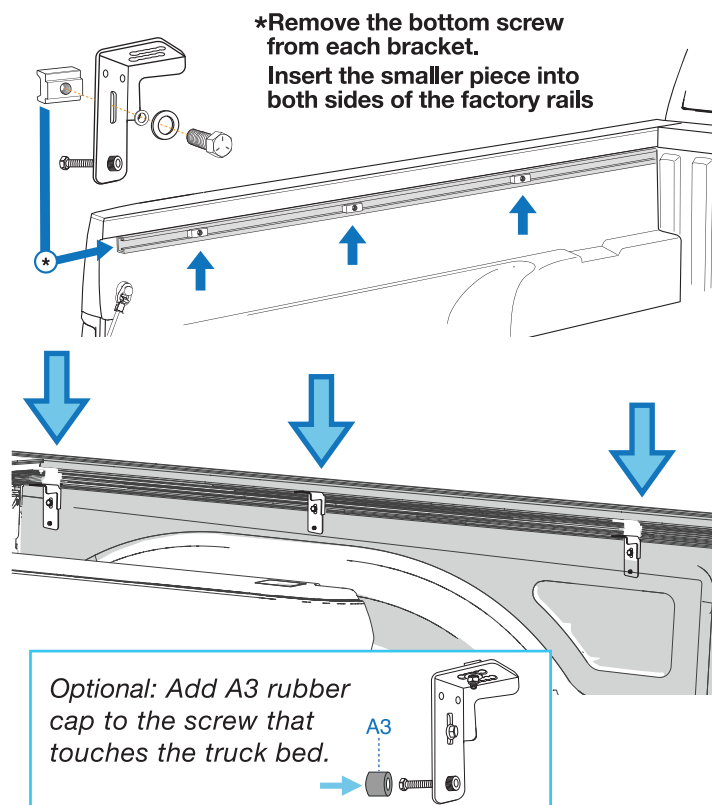
7 Install clamps

First note the slit on each of the clamps, insert clamps to the bolts. There are 6 clamps, one for each bolt. Make sure the slit sits between the B1 t-slot nut and the B3 washer of the bolt.

Note: Push clamp against the side of the rail cap while using 10mm wrench to tighten B5 nuts.



Make sure the clamps are properly clamped onto the truck bed under the rail and the rails are pushed down before tightening the bolt and the clamp. ***IMPORTANT*** Rails must be pushed down while tightening the clamps to ensure the complete seal at the tailgate.



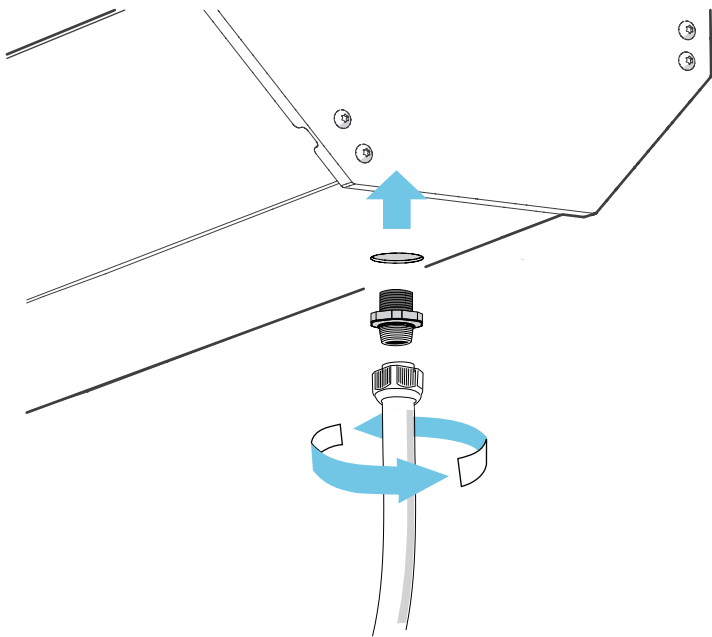
8

Install drainage tubes

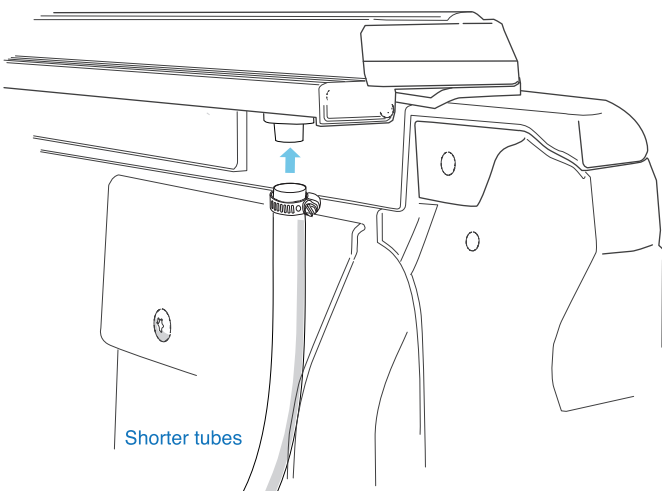
Lock two tubes under the canister using the black connectors. Hook the other two tubes onto the end of the rails, tightened. Insert the rest of the tubes to the holes on the truck bed.

Note: Here that not all trucks have predrilled holes, you may need to drill small holes just big enough to plug tubes in that leads out from the bed.

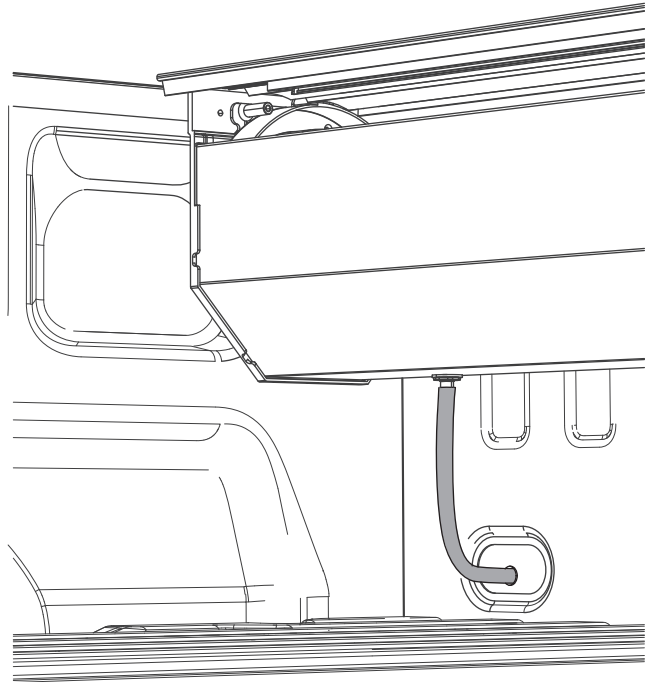
Drain tube for canister



Drain tube for rail



Generally the drain tubes will be routed out through a hole drilled in the factory bed plug. Other a suitable existing hole must be utilized. Or a new hole can be drilled, taking great caution to be aware of lines and anything behind where the hole is drilled.



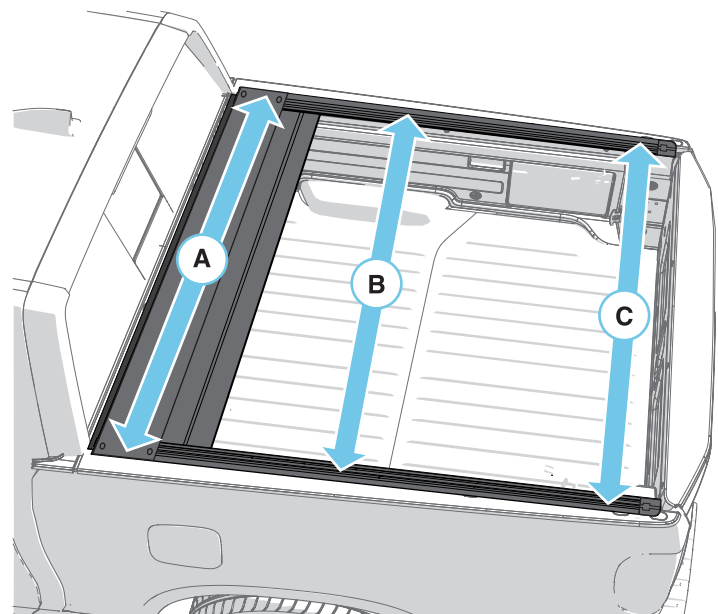
9

Final Check

Make sure A, B, and C are equidistant. Measure the distance between the rails at these three locations. Make sure the distance stays the same ($\pm 1/16"$ as at point A) and parallel.

Note: Rails distance adjustment shown on STEP 5A

Note: Remove distance bar



For safety purpose

- Never stand, sit or ride on the cover or allow others to do so.
- Do not allow people or animals to occupy bed with the cover closed.
- Keep cover closed when going through auto car wash.

Additional clarification and information

Here are some common questions and concerns buyers often have on the product design, we will address each one of them in the points below, to reassure you the quality of our product

- *Lock and Unlock*

See next page

- *Adjust rolling speed*

Check and change the tightness of the screw on the right side of the canister, rotate the screw clockwise for faster and counter clockwise for slower rolling. Do 30 revolutions at a time, if the cover is still rolling too slow or too fast after 30 revolutions, do another 30 revolutions to get a more visible result. (Image 1)

- Cover may be rolling fast now since some customers suggest rolling is too slow. This is completely normal not an issue and the speed is also adjustable as stated. Additionally, after long use the spring inside will naturally slow down the rolling speed as well.

- *Use the strap*

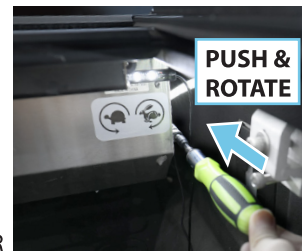
When the cover is close to fully retracted, hold the pull strap and allow it to slip through your fingers to prevent a heavy slam on the canister, this helps keeping the product in working condition for a longer period of time.



Image 1



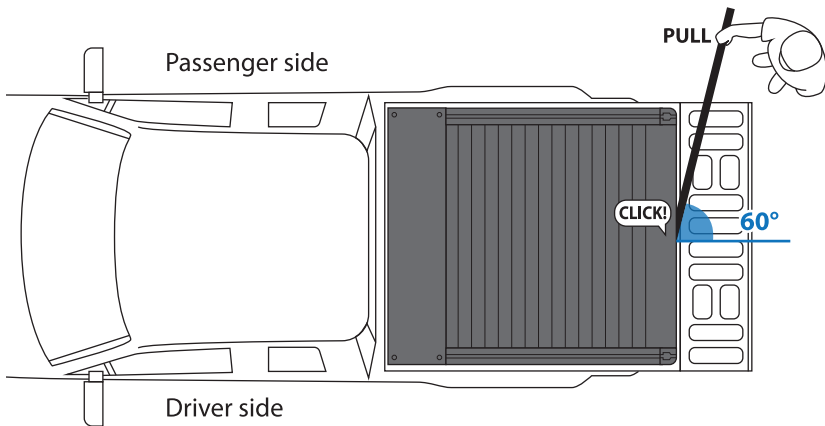
5/16"
NUT DRIVER



Warranty information

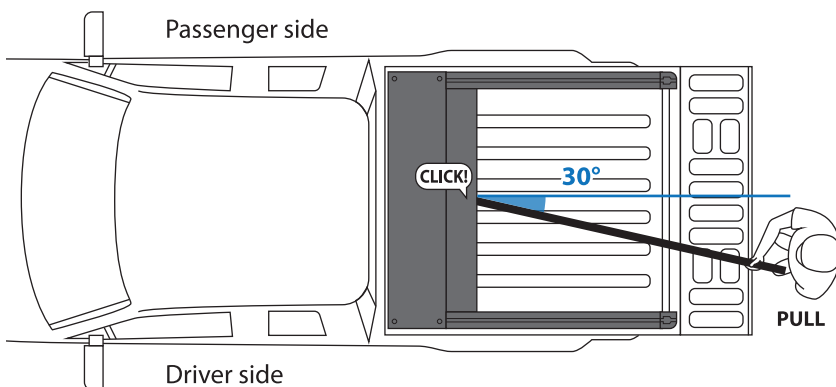
We take responsibility over our product, please contact us for any kind of concern or inquiry regarding your purchase. There is a **one-year warranty** on this tonneau cover. To contact our service team, find us at <https://jcwinauto.com> or send an email to jcwinauto@gmail.com, we normally respond within 24 hours during business hours, closed on weekend.

HOW TO OPEN, CLOSE AND STOP



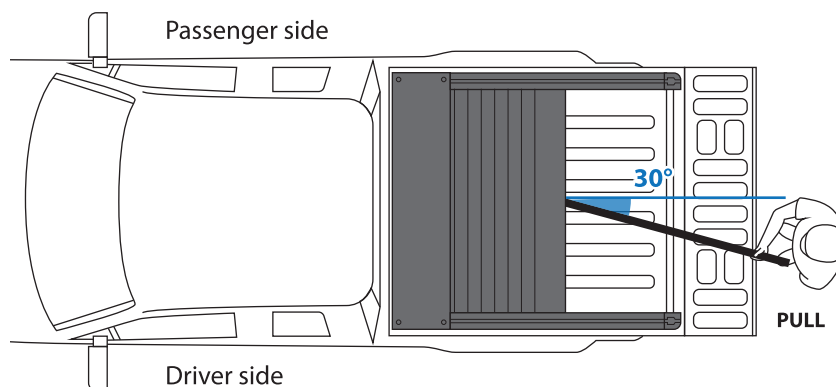
OPEN

Let the cover roll slowly



CLOSE

Pull the cover towards tailgate



STOP MIDWAY

When closing, pull the cover, then slowly release the strap

OR

When opening, move to the driver side rear after the cover starts rolling

Auto-Retractable Tonneau Cover Installation Guide

Fit 5 models

Ford F-150/F-250/F-350 Ram 1500/2500/3500
Chevrolet Silverado 1500/2500/3500
GMC Sierra 1500/2500/3500 Tundra

6FT / 6.5FT / 6.8FT TRUCK BED




JCWIN AUTO®


SYNETICUSA®



jcwinauto@gmail.com
ebay@syneticusa.com



<https://jcwinauto.com/>
<http://syneticusa.com/>



facebook.com/jcwinauto
facebook.com/SyneticUSA



We highly recommend watching the video prior to starting the installation. Please

scan this QR code

to see our full installation video of this product first! Before installing, please check to make sure the retraction mechanism works. If the triangular piece does not retract on either side of the cover, stop at once and contact us for assistance first.



SCAN ME

See full installation video [here](#). Before installing, please check to make sure the retraction mechanism works. If the triangular piece does not retract on either side of the cover, stop at once and contact us for assistance first.

Components

Main cover x1
Rails x2
Cover panel x1
Foam roll x2
Tube x4
Tube connector x4
5in screw x6 (Silverado only)
A clamp x6
A2 wrench x1

A3 rubber cap x6
A4 bolt plate x2
E lubricating oil
B1 T-slot screws x6
B3 washer(L) x6
B4 washer(S) x6
B5 10mm hex nut x6
C1 screw x4

C2 washer(L) x4
C3 washer(S) x4
C4 wrench x1
C5 plastic washer x4
D1 screw x4
D2 T-slot nut x4
D3 wrench x1
D4 screw cap x4
D5 cap washer x4



CAUTION: Over torquing hardware may damage components.

Parts Diagram

FIG 1

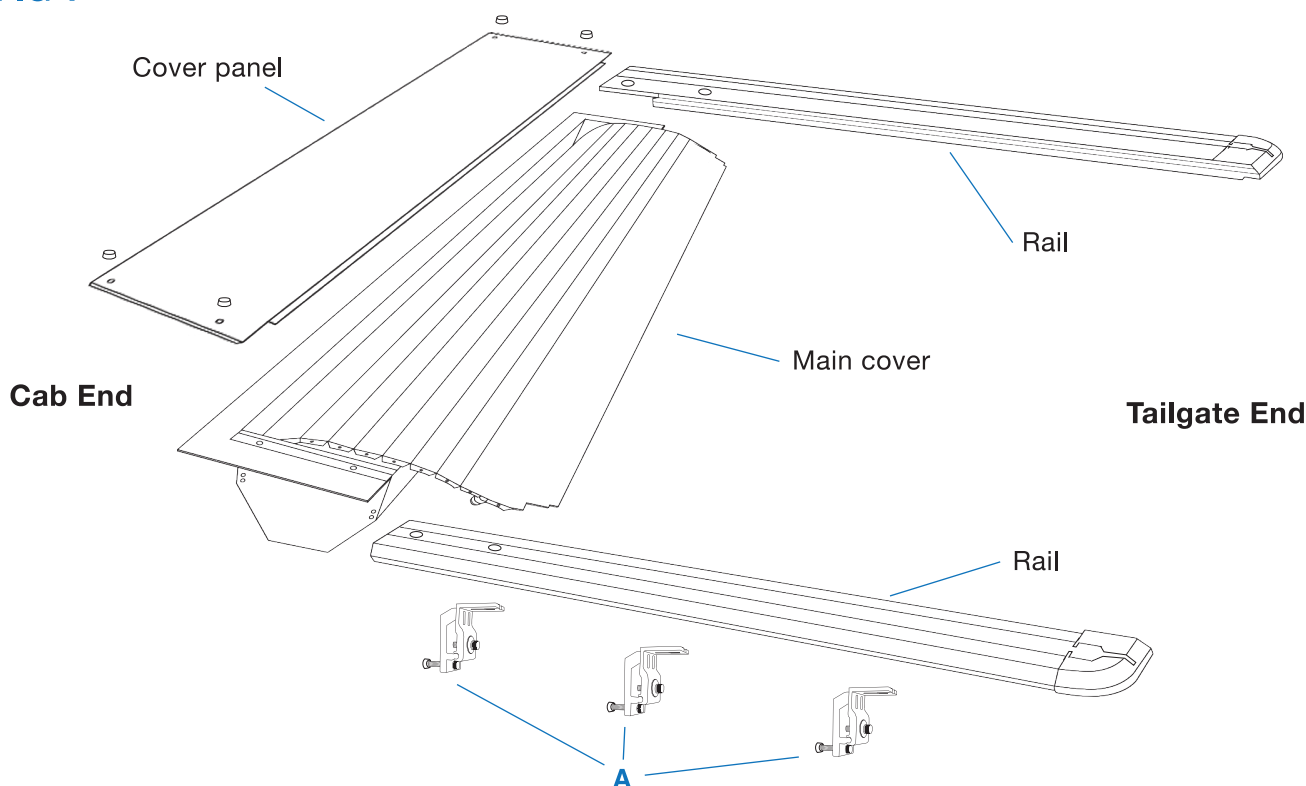


FIG 2

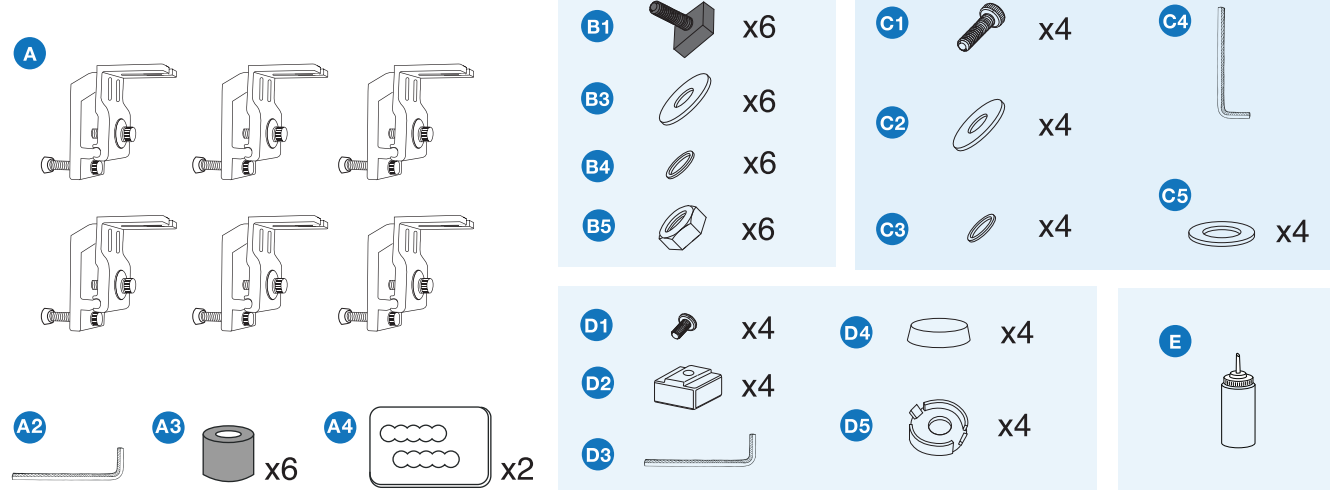
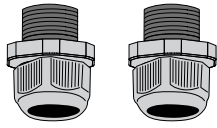
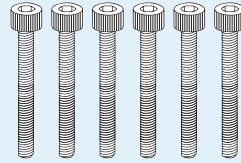
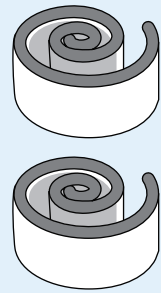
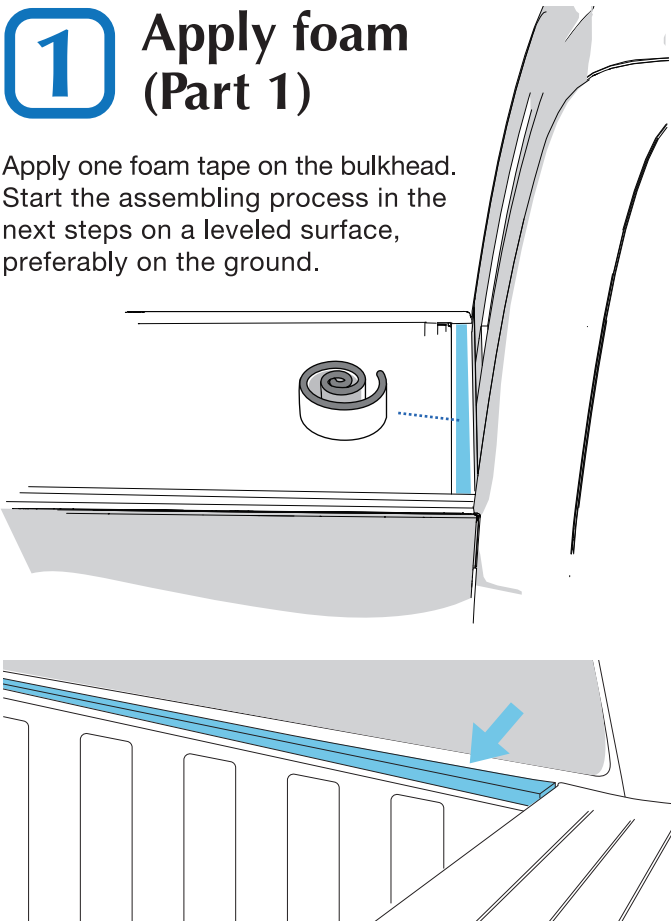


FIG 3**Drain tubes****5in screws *SILVERADO ONLY*****Foam rolls**

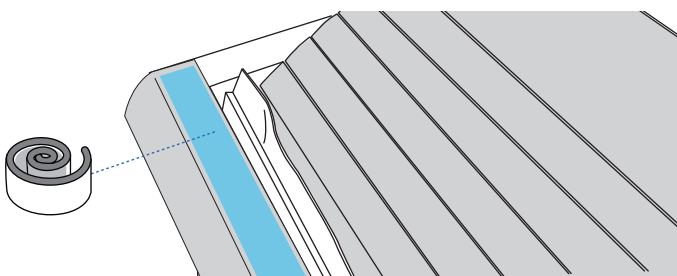
1 Apply foam (Part 1)

Apply one foam tape on the bulkhead. Start the assembling process in the next steps on a leveled surface, preferably on the ground.



2 Apply foam (Part 2)

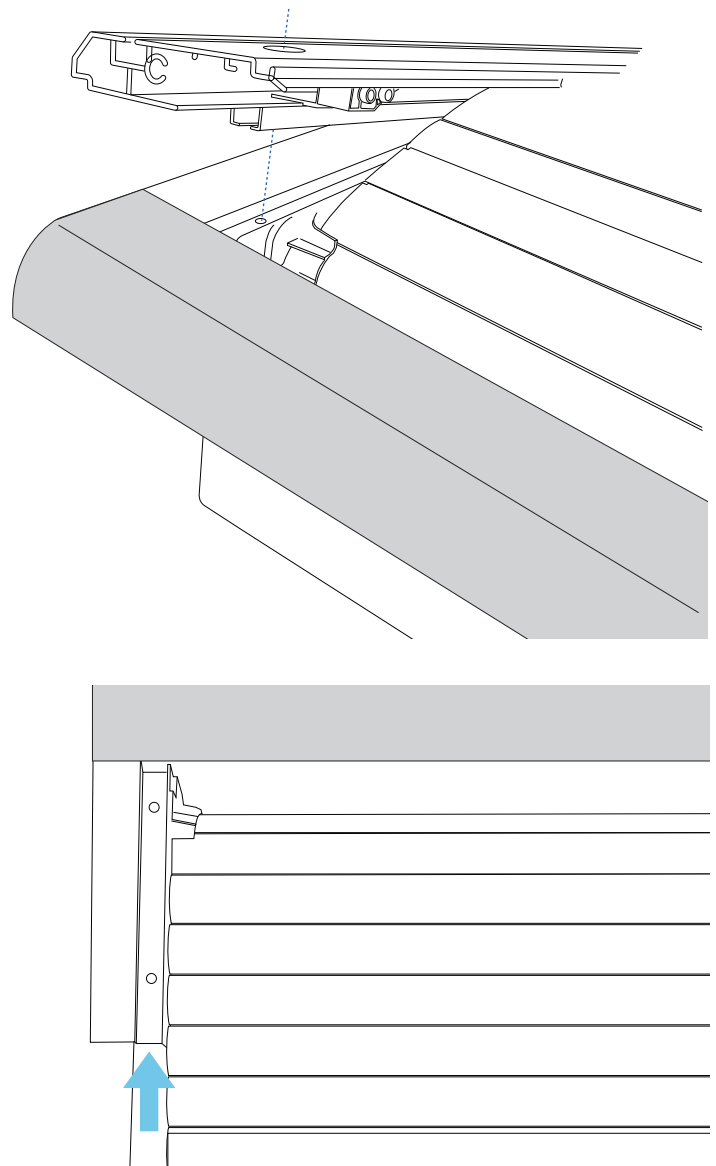
Apply the wider foam roll on the front of the cover, across the white bar as shown. Both foam rolls are applied to ensure full waterproof function of the item.



3 Install rails

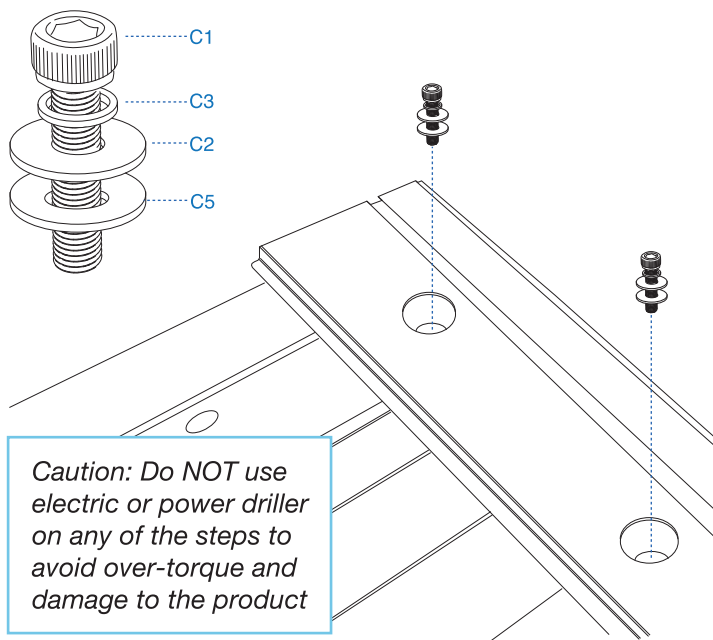
Install the rails onto the cover.

Note: The sides of the cover, next to the white part, there is small black strip that is supposed to slide and clip right into a tunnel under the rail, see photo.



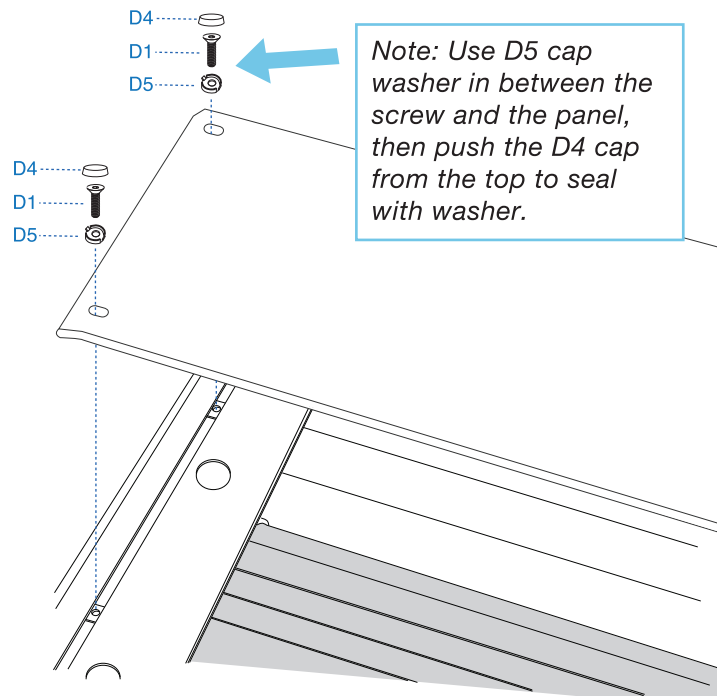
4A Install rails

With the rails in place and the cover slid into the rail channel, attach the rails with the four C1 mounting screws.



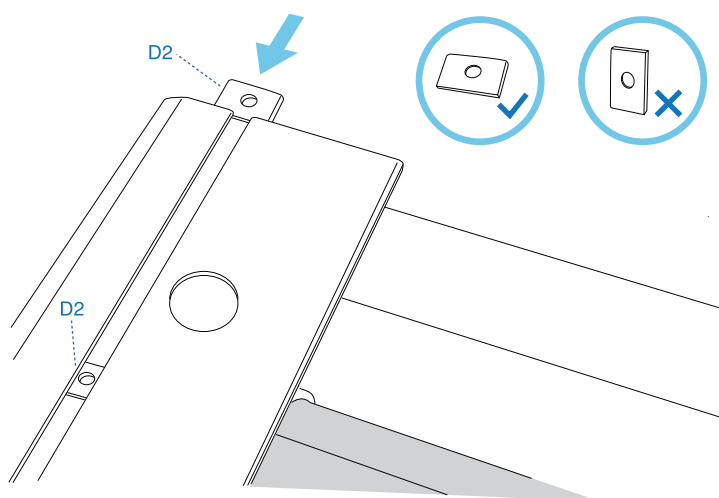
4c Lock panel (Part 2)

Place the panel on top of the cover, then adjust the nuts in the groove to align with holes on the panel. Finally, use wrench on the D1 screws to fix the panel onto the cover assembly.



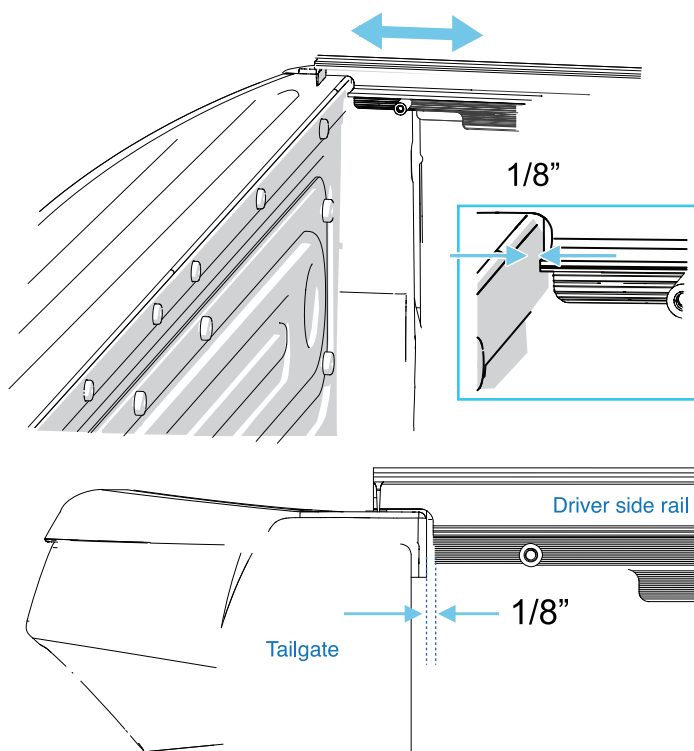
4B Lock panel (Part 1)

Lock the panel onto the cover. First, slide two D2 screw locks into the groove on the rail, make sure the wider side goes in, not the shorter side. If done correctly, the locks should not move loosely once inserted inside. Do this for the other rail. The tip of the wrench can be used here to help sliding the lock in or out.



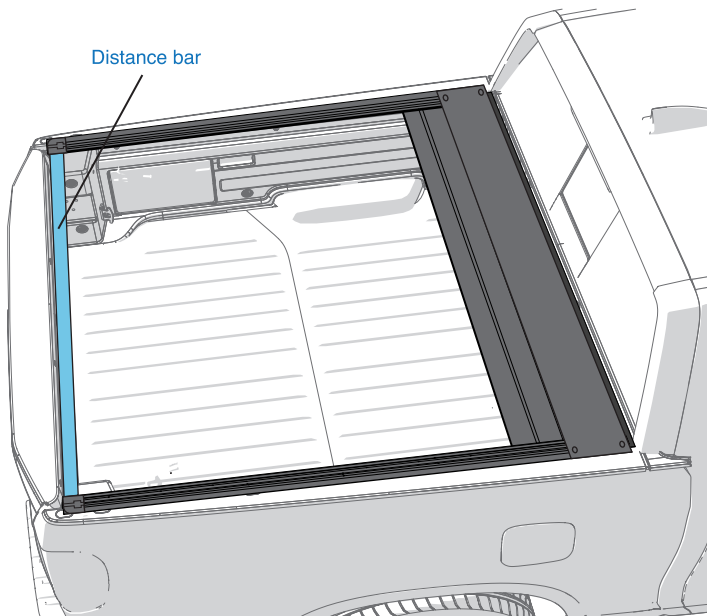
5A Adjust position (Part 1)

Pull the cover assembly back towards the tailgate, ensure 1/8" gap in between the tailgate and rails. Make certain the rails do not move after measuring.



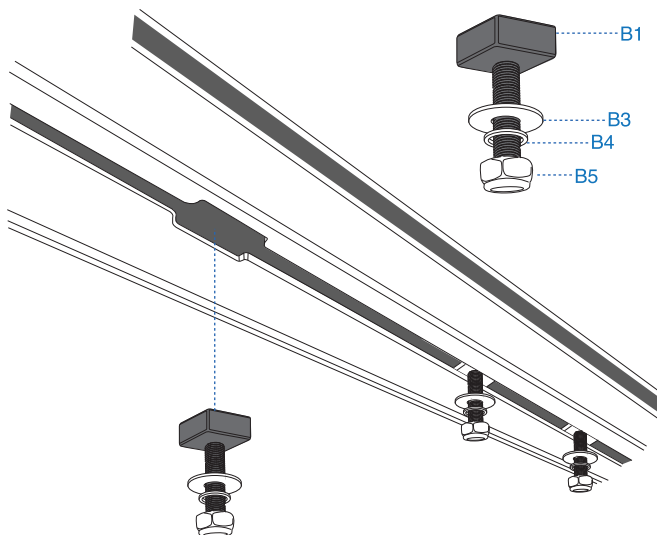
5B Adjust position (Part 2)

Lift the cover and set down on the truck bed, the front of the main cover should sit above the foam that was applied. Install the distance bar to check rail position. Insert the distance bar as below, make sure the distance bar reach the end of the rail.



6 Clamp prep work

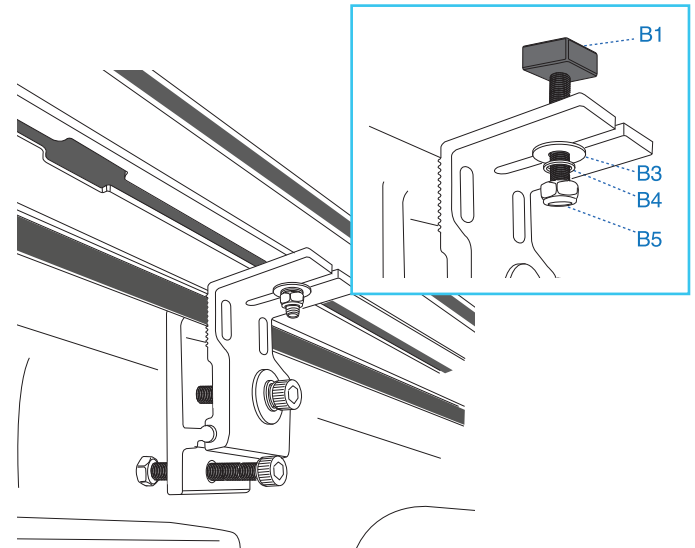
Now check under the rail for another groove and look for an opening on the groove. Insert 3 of the assembled bolts into the opening one at a time, and slide them towards the front, middle, and the back of the rail. Do this for the other rail. Clamps will go on these places.



7 Install clamps

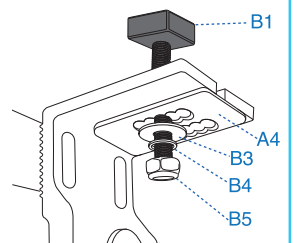
First note the slit on each of the clamps, insert clamps to the bolts. There are 6 clamps, one for each bolt. Make sure the slit sits between the B1 t-slot nut and the B3 washer of the bolt.

Note: Push clamp against the side of the rail cap while using 10mm wrench to tighten B5 nuts.

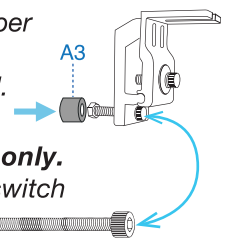


Make sure the clamps are properly clamped onto the truck bed under the rail and the rails are pushed down before tightening the bolt and the clamp. ***IMPORTANT*** Rails must be pushed down while tightening the clamps to ensure the complete seal at the tailgate.

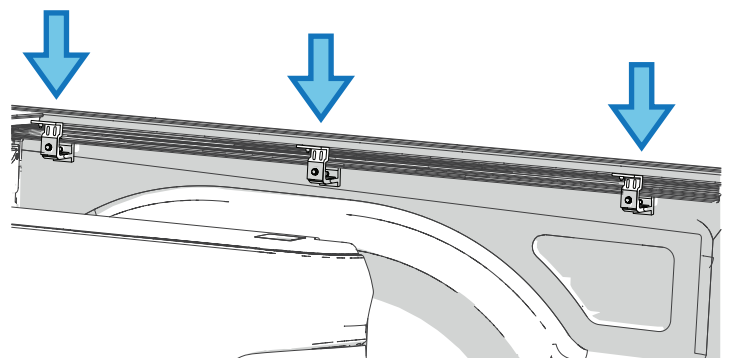
Optional: Add A4 plates to the two clamps closest to the tailgate, one on each rail. Caution! Holes on both plates must match. If one clamp uses the 2nd hole the other clamp must do too.



Optional: Add A3 rubber cap to the screw that touches the truck bed.



Note: For Silverado only. If screw is too short, switch it to the 5in screw.

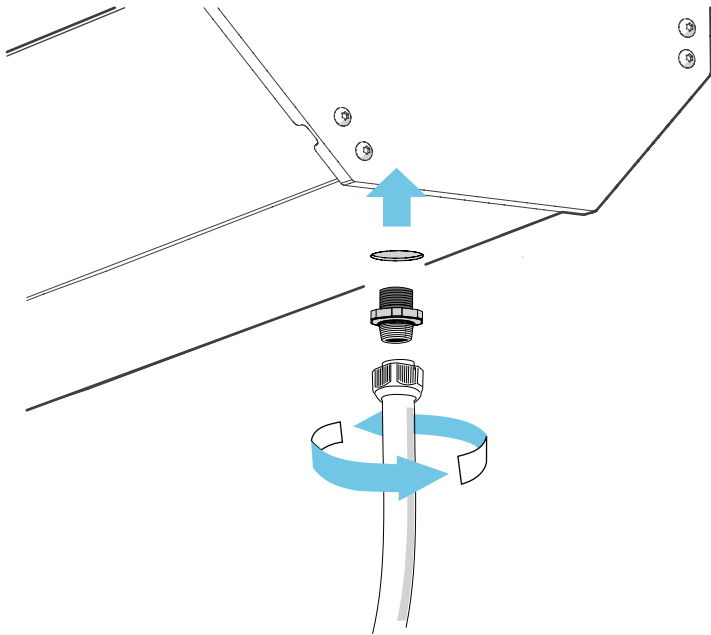


8 Install drainage tubes

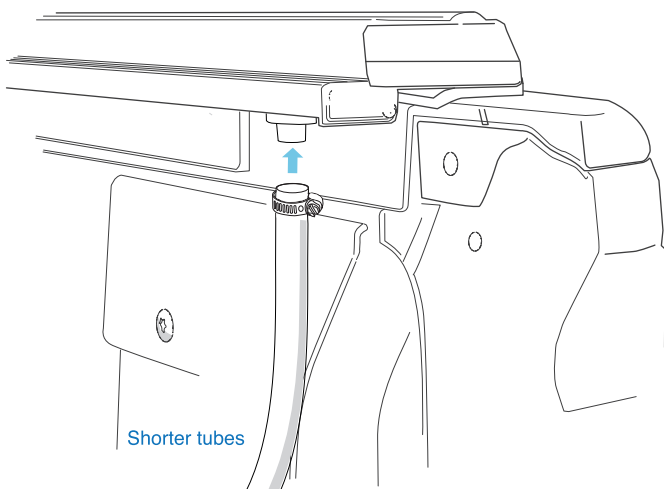
Lock two tubes under the canister using the black connectors. Hook the other two tubes onto the end of the rails, tightened. Insert the rest of the tubes to the holes on the truck bed.

Note: Not all trucks have predrilled holes, you may need to drill small holes just big enough to plug tubes in that leads out from the bed.

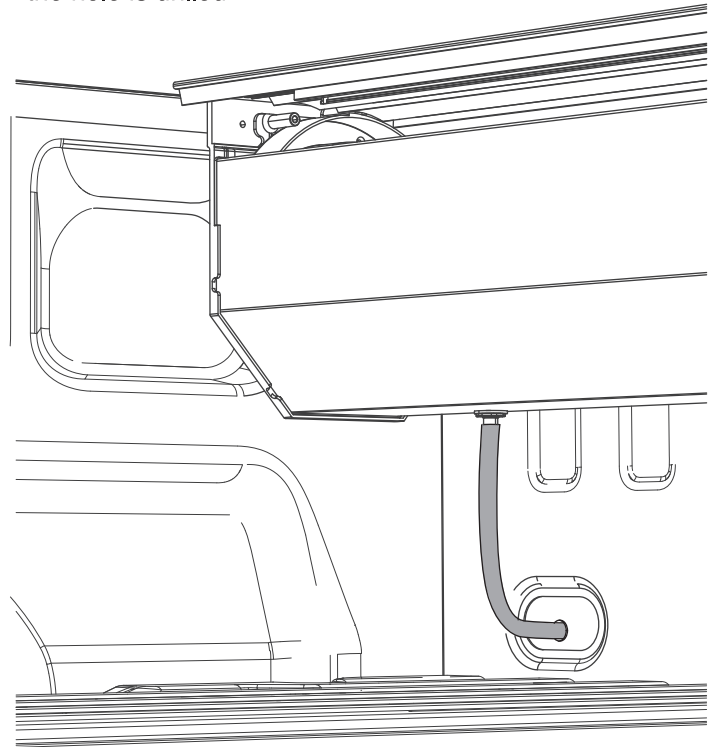
Drain tube for canister



Drain tube for rail



Generally the drain tubes will be routed out through a hole drilled in the factory bed plug. Other a suitable existing hole must be utilized. Or a new hole can be drilled, taking great caution to be aware of lines and anything behind where the hole is drilled.

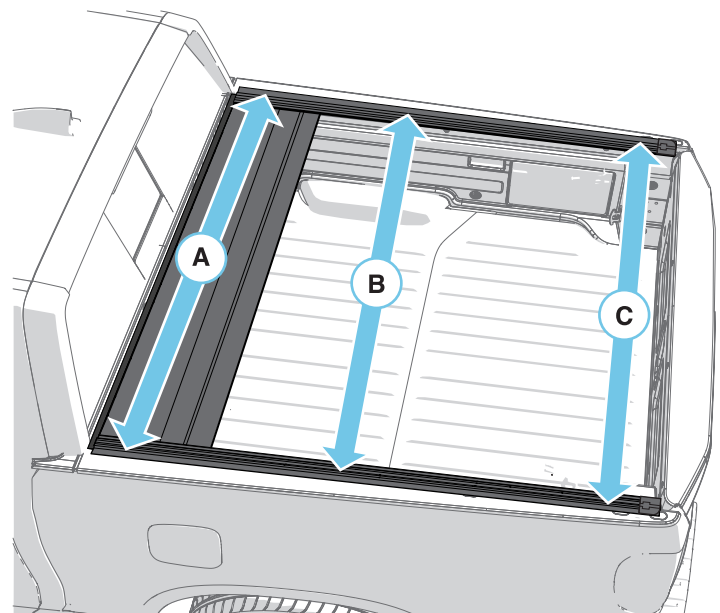


9 Final Check

Make sure A, B, and C are equidistant. Measure the distance between the rails at these three locations. Make sure the distance stays the same ($\pm 1/16"$ as at point A) and parallel.

Note: Rails distance adjustment shown on STEP 5A

Note: Remove distance bar



For safety purpose

- Never stand, sit or ride on the cover or allow others to do so.
- Do not allow people or animals to occupy bed with the cover closed.
- Keep cover closed when going through auto car wash.

Additional clarification and information

Here are some common questions and concerns buyers often have on the product design, we will address each one of them in the points below, to reassure you the quality of our product

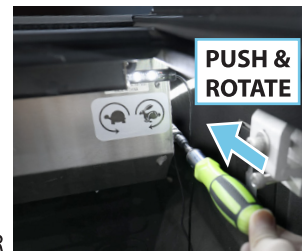
- *Lock and Unlock*
See next page
- *Adjust rolling speed*
Check and change the tightness of the screw on the right side of the canister, rotate the screw clockwise for faster and counter clockwise for slower rolling. Do 30 revolutions at a time, if the cover is still rolling too slow or too fast after 30 revolutions, do another 30 revolutions to get a more visible result. (Image 1)
- Cover may be rolling fast now since some customers suggest rolling is too slow. This is completely normal not an issue and the speed is also adjustable as stated. Additionally, after long use the spring inside will naturally slow down the rolling speed as well.
- *Use the strap*
When the cover is close to fully retracted, hold the pull strap and allow it to slip through your fingers to prevent a heavy slam on the canister, this helps keeping the product in working condition for a longer period of time.



Image 1



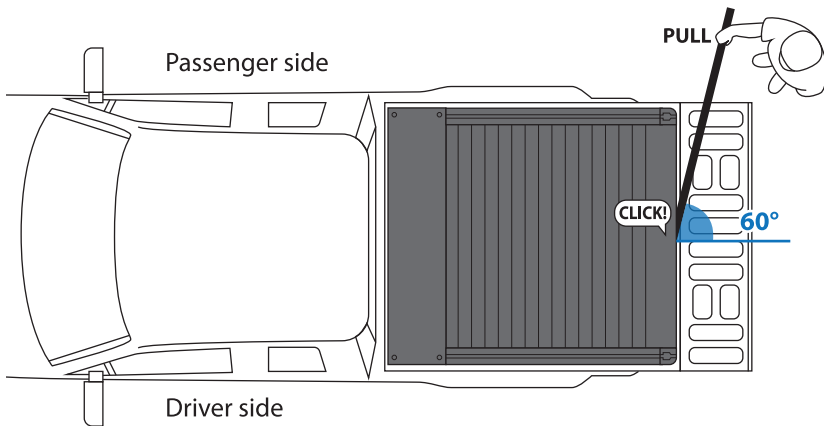
5/16"
NUT DRIVER



Warranty information

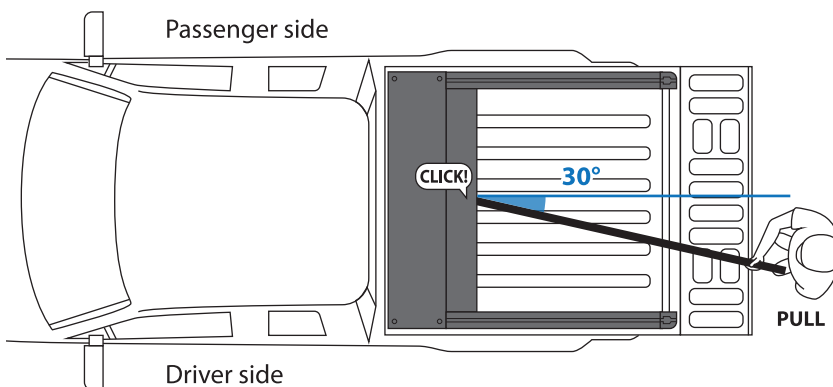
We take responsibility over our product, please contact us for any kind of concern or inquiry regarding your purchase. There is a **one-year warranty** on this tonneau cover. To contact our service team, find us at <https://jcwinauto.com> or send an email to jcwinauto@gmail.com, we normally respond within 24 hours during business hours, closed on weekend.

HOW TO OPEN, CLOSE AND STOP



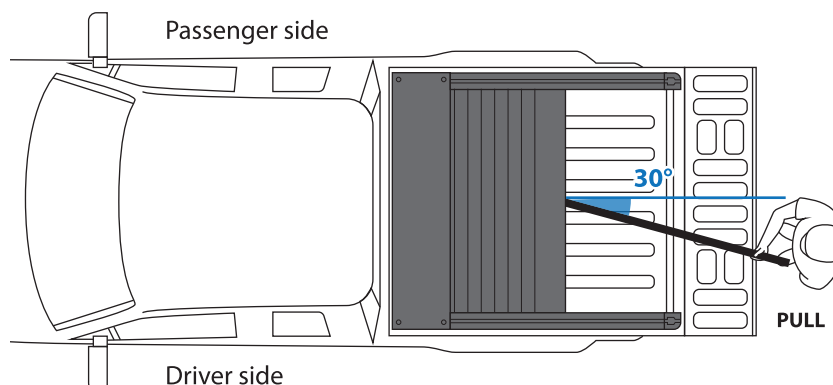
OPEN

Let the cover roll slowly



CLOSE

Pull the cover towards tailgate




STOP MIDWAY

When closing, pull the cover, then slowly release the strap


OR

When opening, move to the driver side rear after the cover starts rolling



 626-360-5034
626-463-8750

 jcwinauto@gmail.com
ebay@syneticusa.com

 <https://jcwinauto.com/>
<http://syneticusa.com/>