

Manual Retractable Tonneau Cover Installation Guide

For Rambox



▶ Watch Full Video Here
<https://bit.ly/4hGzEyR>



jcwinauto@gmail.com
ebay@syneticusa.com



<https://jcwinauto.com/>
<http://syneticusa.com/>



facebook.com/jcwinauto
facebook.com/SyneticUSA

Install Locks Guideline



**WATCH
VIDEO
HERE**

► <https://bit.ly/3CliQrM>

1

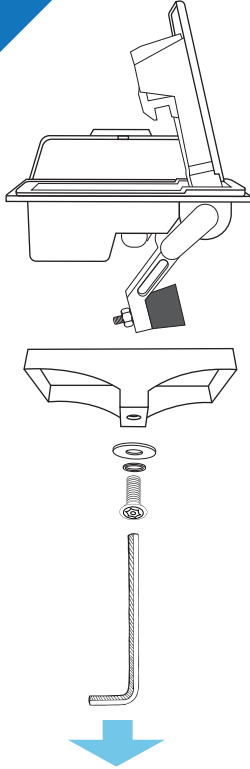

2

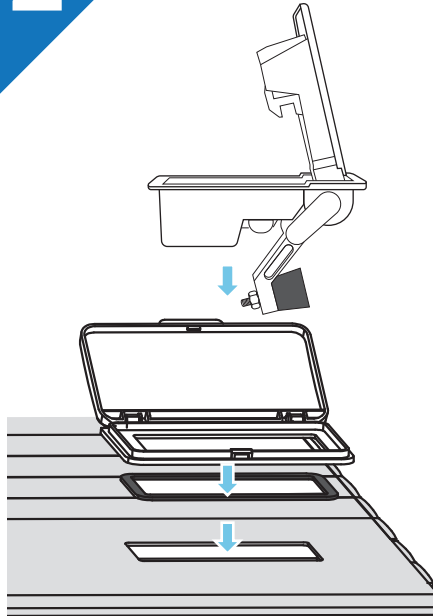

3

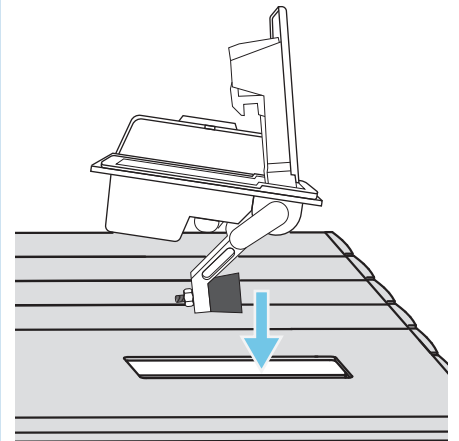

4

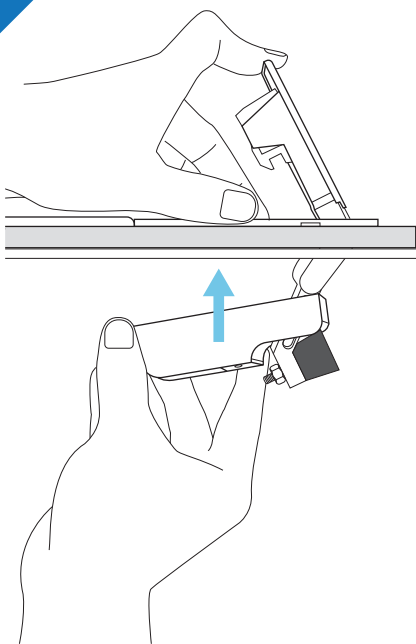

5

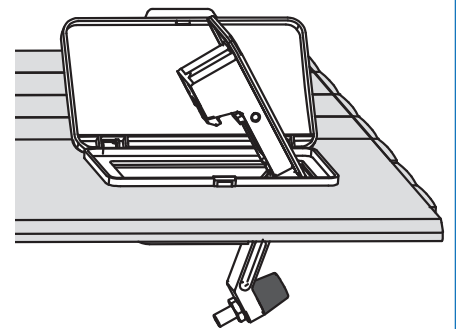
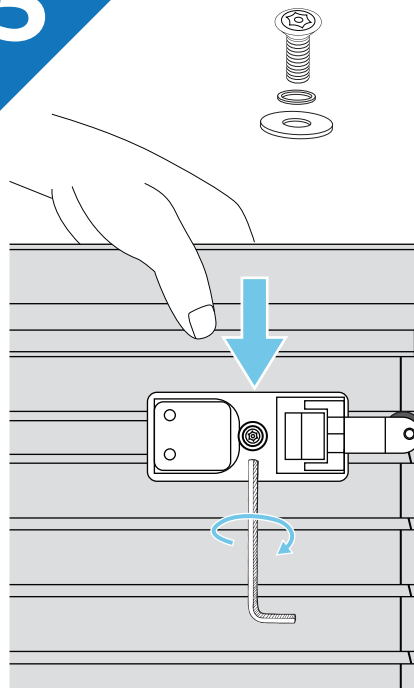

“



We highly recommend watching the video prior to starting the installation. Please

scan this QR code

to see our full installation video of this product first!

”

Components

Main cover x1	E	lubricating oil	C2	washer(L) x4
Rails x2	B1	T-slot screws x6	C3	washer(S) x4
Cover panel x1	B2	washer(L) x6	C4	wrench x1
Foam tape x2	B3	washer(S) x6	C5	plastic washer x4
Tube x4	B4	10mm hex nut x6	D1	screw x6
Tube connector x4	C1	screw x4	D2	T-slot nut x6
Distance bar x1			D3	wrench x1

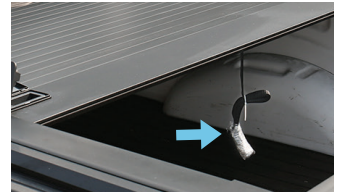

Key for lock x2
(Keys are inside the plastic wrap on the strap hanging from the front of cover. 2 keys for 2 locks, shareable)



CAUTION: Over torquing hardware may damage components.



▶ See full installation video here.

Parts Diagram

FIG 1

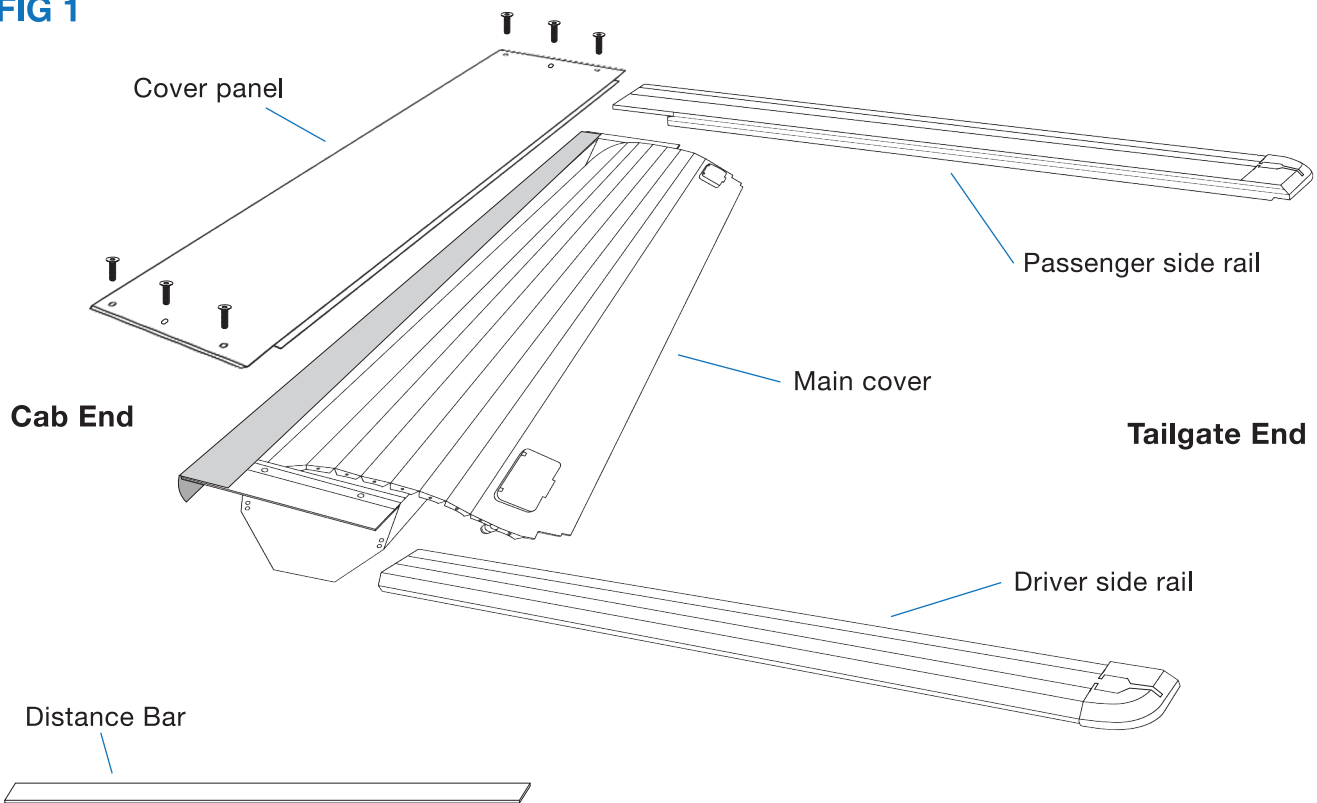

FIG 2

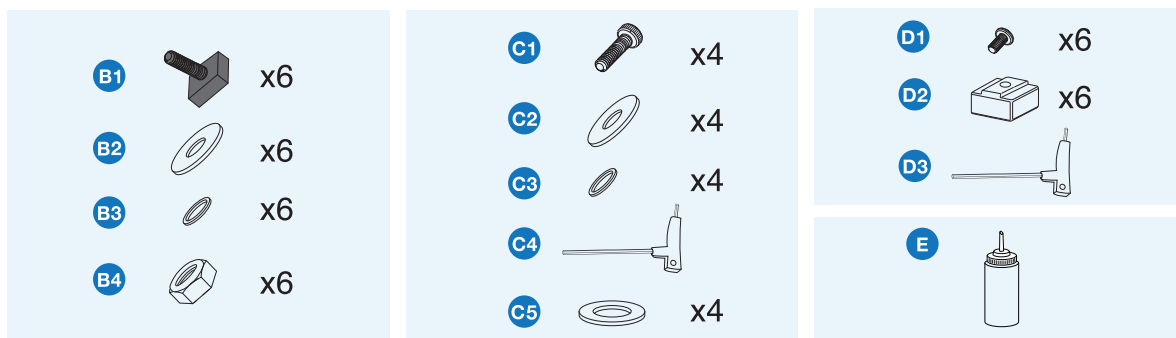
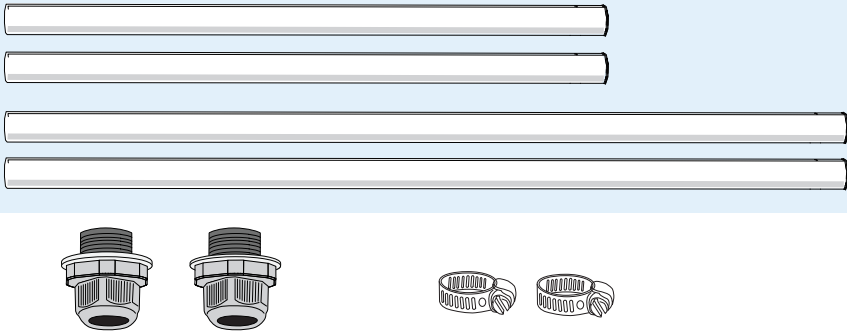
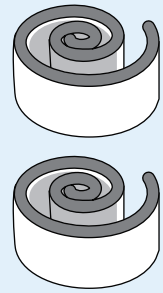
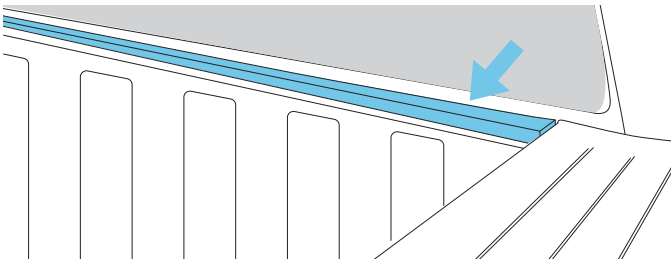
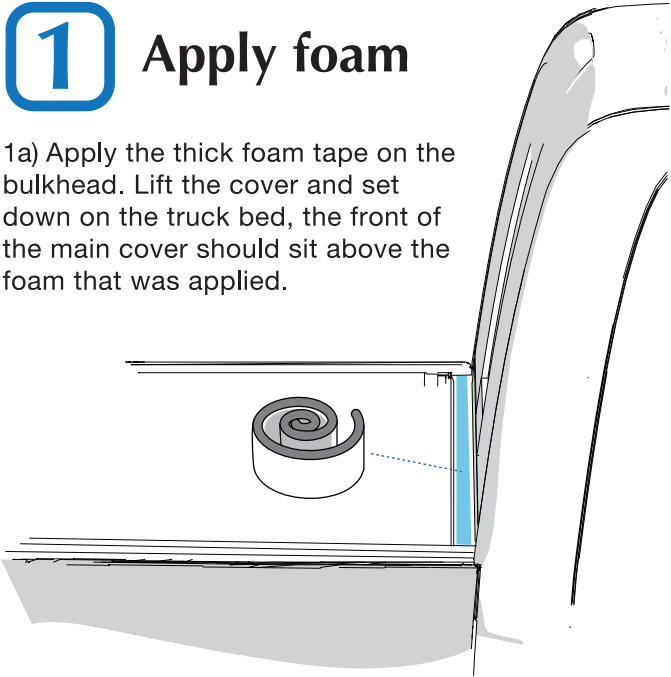

FIG 3**Drain tubes****Foam tapes**

1 Apply foam

1a) Apply the thick foam tape on the bulkhead. Lift the cover and set down on the truck bed, the front of the main cover should sit above the foam that was applied.



1b) Lower cover onto truck bed

2 Disengage locks

Unlock both sides of the cover by pressing on the locks, they need to be unlocked during the installation.

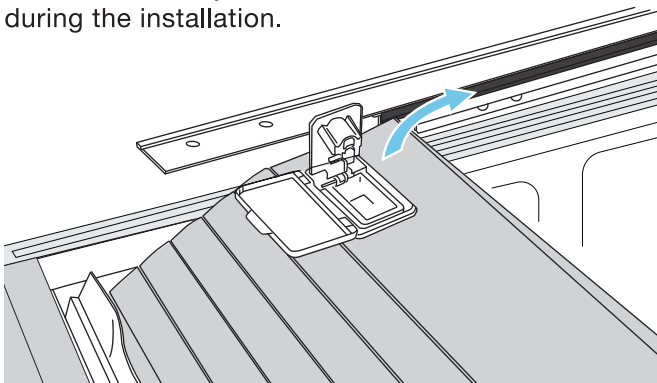

3A Install rails

Guide the cover into the rail channel while positioning the rails into the canister spirals. Align the rail tunnel to the groove highlighted in figure below.

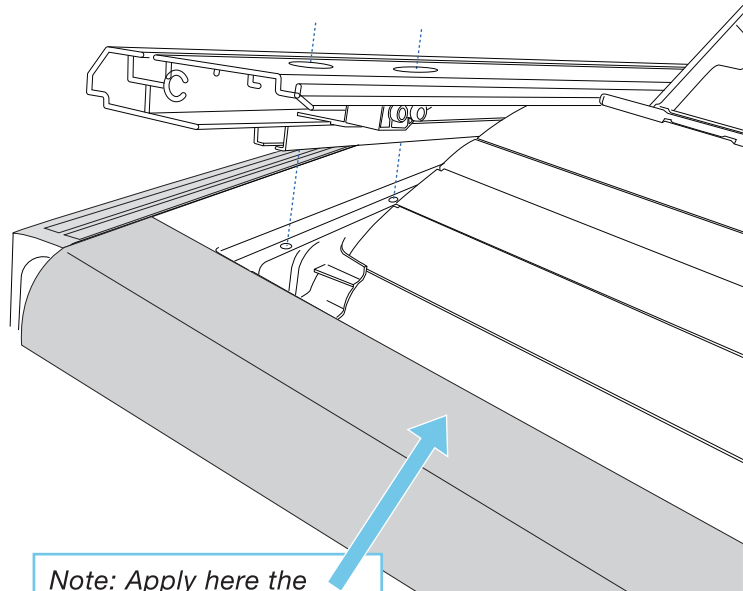

Note: Apply here the other foam tape (see Fig3), it should cover up to both ends of the outer bar.

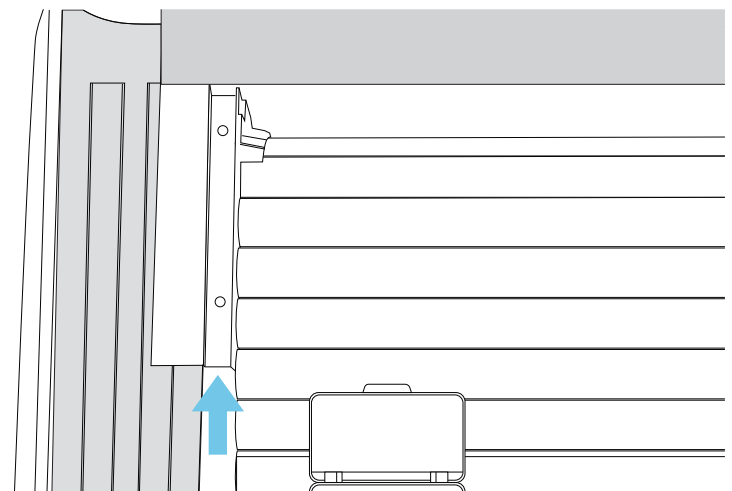

3B

Install rails

With the rails in place and the cover slid into the rail channel, attach the rails with the four C1 mounting screws.

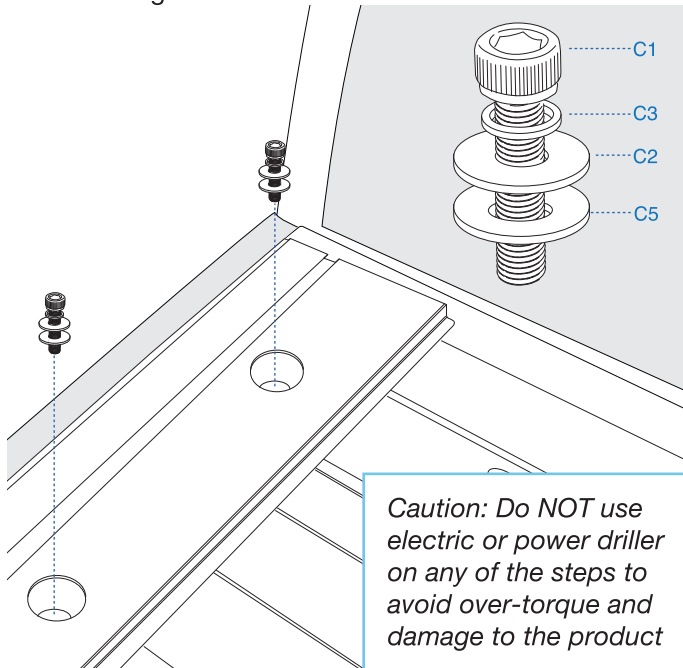

4B

Install cover panel (Part 2)

Place the panel on top of the cover, then adjust the nuts in the groove to align with holes on the panel. Finally, use wrench on the D1 screws to fix the panel onto the cover assembly.

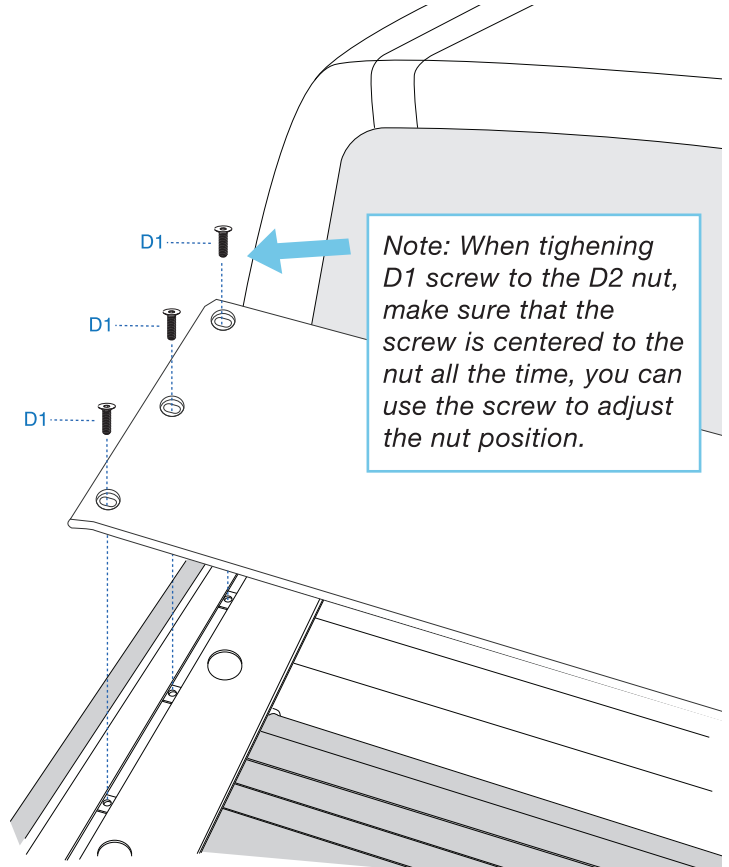

4A

Install cover panel (Part 1)

First, slide three D2 t-slot nuts into the groove on the rail, make sure the wider side goes in, not the shorter side. If done correctly, the nuts should not move loosely once inserted inside. Do this for the other rail.

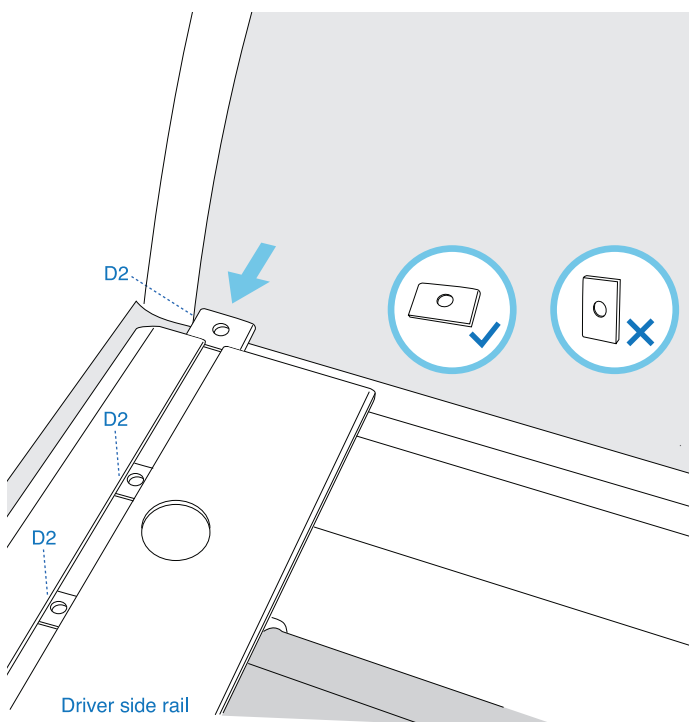

5A

Adjust position (Part 1)

Install the distance bar to check rail position. Insert the distance bar as below, make sure the distance bar reach the end cab of rail.

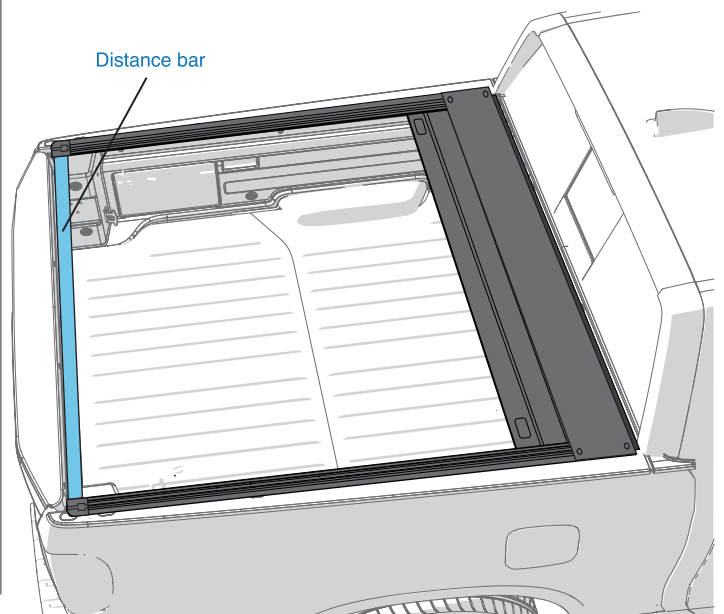

5B

Adjust position (Part 2)

Pull the cover assembly back towards the tailgate, ensure 1/8" gap in between the tailgate and rails. Make certain the rails do not move after measuring.

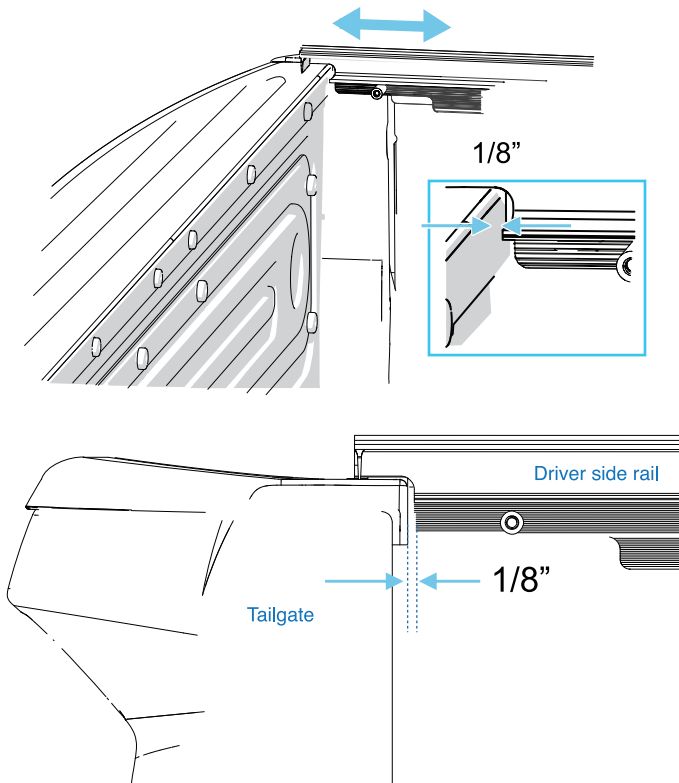

6

Rail-to-Rail

Check under the cover's bed rail for a groove with openings, insert 3 of the bolts into the opening, and slide them towards the front, middle, and the back of the rail where the openings align with those from the adapter rail, then tighten the bolts using nut and washer as shown.

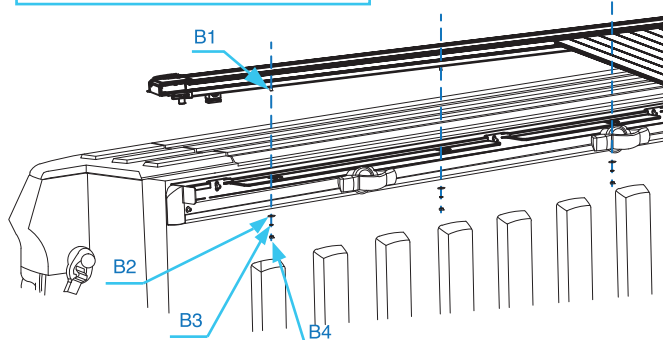
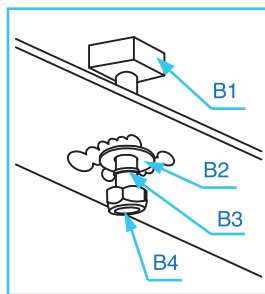
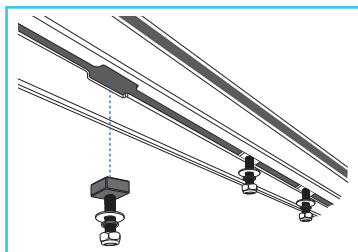

7

Install drainage tubes

Lock two tubes under the canister using the black connectors. Hook the other two tubes onto the end of the rails, tightened. Insert the rest of the tubes to the holes on the truck bed.

Note: Not all trucks have predrilled holes, you may need to drill small holes just big enough to plug tubes in that leads out from the bed.

Drain tube for canister

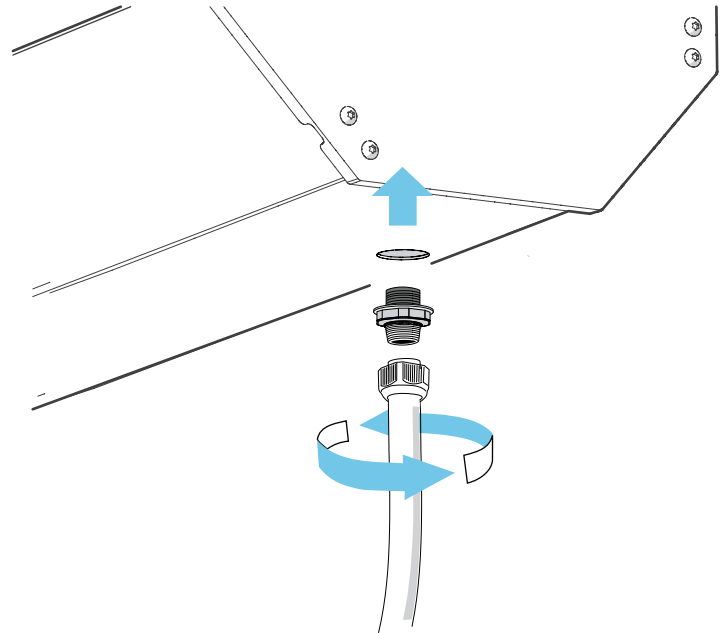

Drain tube for rail

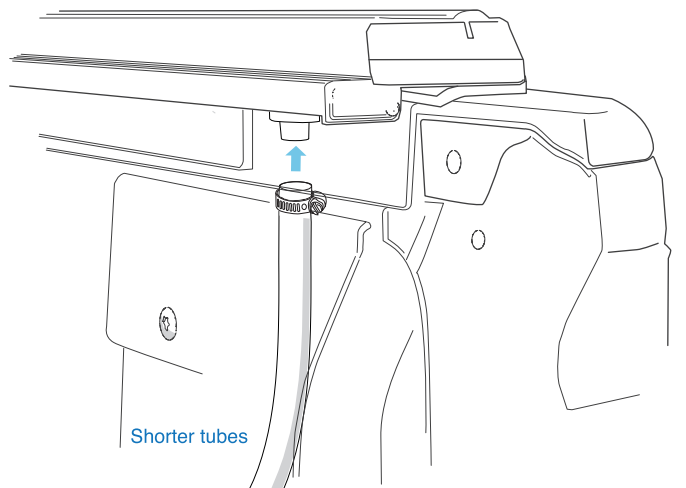

8 Final Check

Make sure A, B, and C are equidistant. Measure the distance between the rails at these three locations. Make sure the distance stays the same ($\pm 1/16$ " as at point A) and parallel.

Note: Rails distance adjustment shown on STEP 5A

Note: Remove distance bar

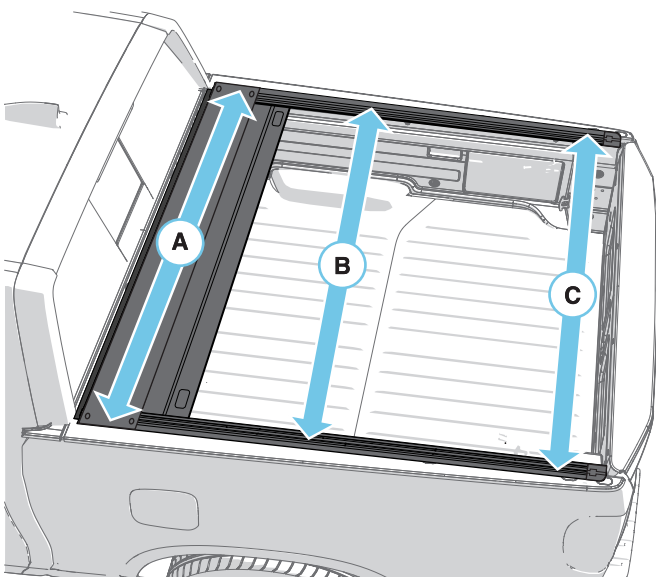

9 Peel and Stick

Remove the adhesive from the bottom side of the rubber strip and paste the rubber strip to the top of the bed frame.

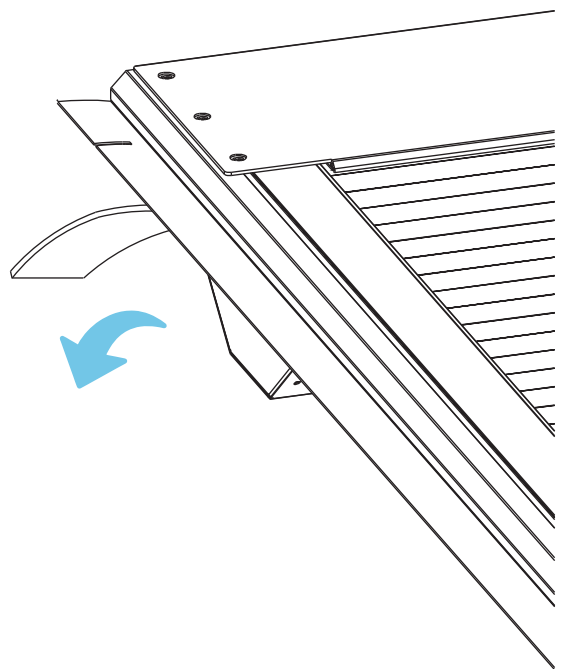

For safety purpose

- Never stand, sit or ride on the cover.
- Do not allow people or animals to occupy bed with the cover closed.
- Keep cover closed when going through auto car wash.
- Clean the debris off the cover before opening to prevent cover stuck and clogged up drain in the canister.
- Check clamps are tightened as needed from time to time.
- Do NOT use heavy chemicals but mild soap and water to clean the cover.
- Check and make sure tubes are clean and without obstruction inside from time to time.



2 keys shareable





Find the keys here

Warranty information

We take responsibility over our product, please contact us for any kind of concern or inquiry regarding your purchase. There is a **one-year warranty** on this tonneau cover. To contact our service team, find us at **<https://jcwinauto.com>** or send an email to **jcwinauto@gmail.com**, we normally respond within 24 hours during business hours, closed on weekend.



 626-360-5034
626-788-7436

 jcwinauto@gmail.com
ebay@syneticusa.com

 <https://jcwinauto.com/>
<http://syneticusa.com/>