

# MANUAL RETRACTABLE TONNEAU COVER Installation Guide



---

Fit: Toyota Tacoma

---

## WHAT YOU WILL NEED

**9/16" Wrench (Ratchet works best)**

2 shareable keys for both locks are included, located inside the plastic wrap at the end of the strap hanging from the cover.



## ATTENTION

Tube connector is inside the tool box, this is right in the middle of the card board, please take out the box before discarding!



eBay@synteticusa.com  
amazon@synteticusa.com



562-821 5057  
626-803 8088



Limited lifetime warranty  
Powder coated black - 1 YEARS

# Remove Lock Protector Guideline

## ATTENTION

The locks are protected by an extra layer of plastic block, to avoid any damage, it is removable after loosening that one screw. **Please remember to put the screw back in afterwards.**

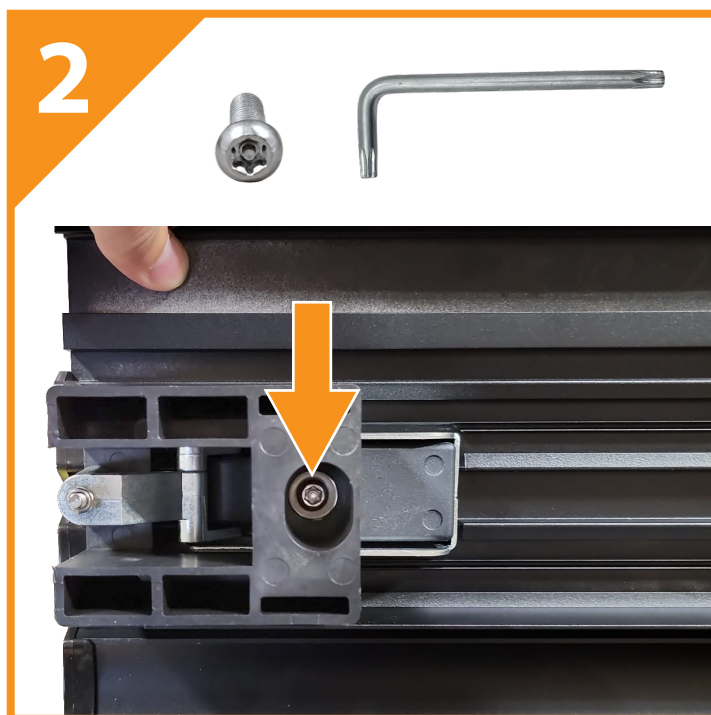
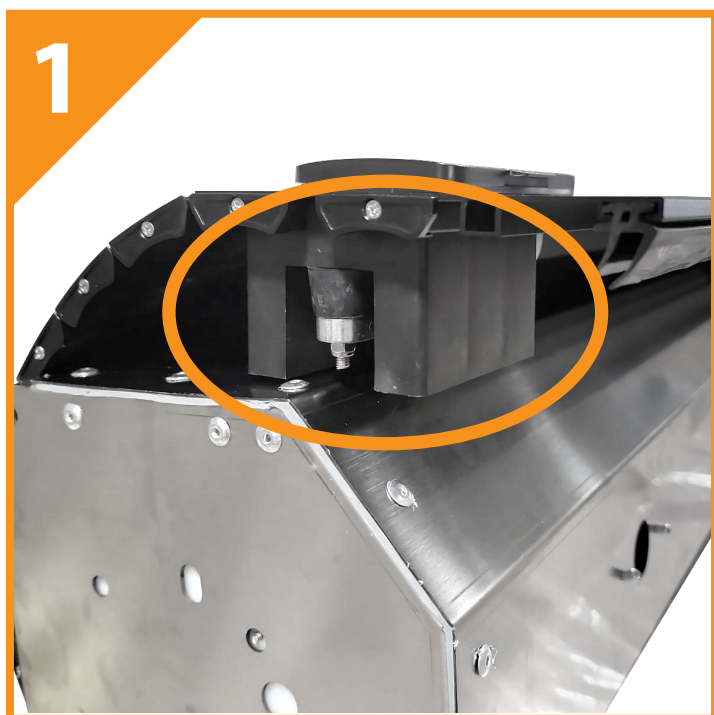

## ! ATTENTION

### Check before installation

- Remove content from box. Verify all parts are present
- Read instructions carefully before starting installation
- DO NOT over torque. Standard operating load for tighten body mount



## ! WARNING

### Heavy object.

To avoid muscle strain or back injury, use lifting aids and proper lifting techniques when removing or replacing.

● (Rails + 5.5ft cover) ~75lb ● (Rails + 6.5ft cover) ~90lb

## PARTS LIST

Qty	Part Description	Qty	Part Description
1 Set	Front Cover	4	Clamps with bolts(E) (6Clamps for 6' beds)
1 Set	Complete Canister Assembly	2	Waterproof Pad (F)
1 Set	Driver Side Rail	1	Lubricating Oil (G)
1 Set	Passenger Side Rail	1	M6 Tamper Resistant Hex L-wrench (H)
4	M6-1x12mm tamper resistant Hexalobular socket button head screws (A) <i>*For Rail to Canister</i>	2	Large Drain Tubes For Canister(J)
4	M6-1x8mm tamper resistant Hexalobular socket button head screws (B) <i>*For Front Cover</i>	2	Small Drain Tubes For Side Rail(K)
2	10mm Hex Head Nut (C) For Rail front tab To Canister	1	Plastic Pad (M)
4	M6 Flat Washer (D) For Front Cover	1	Distance bar
2	Keys for lock (Keys are inside the plastic wrap on the strap hanging from the front of the cover 2 keys for both locks, shareable)		

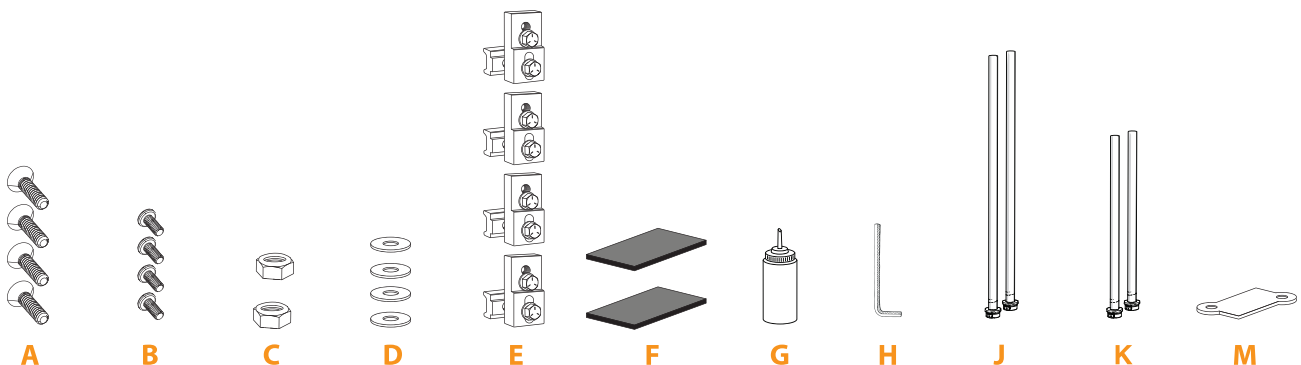
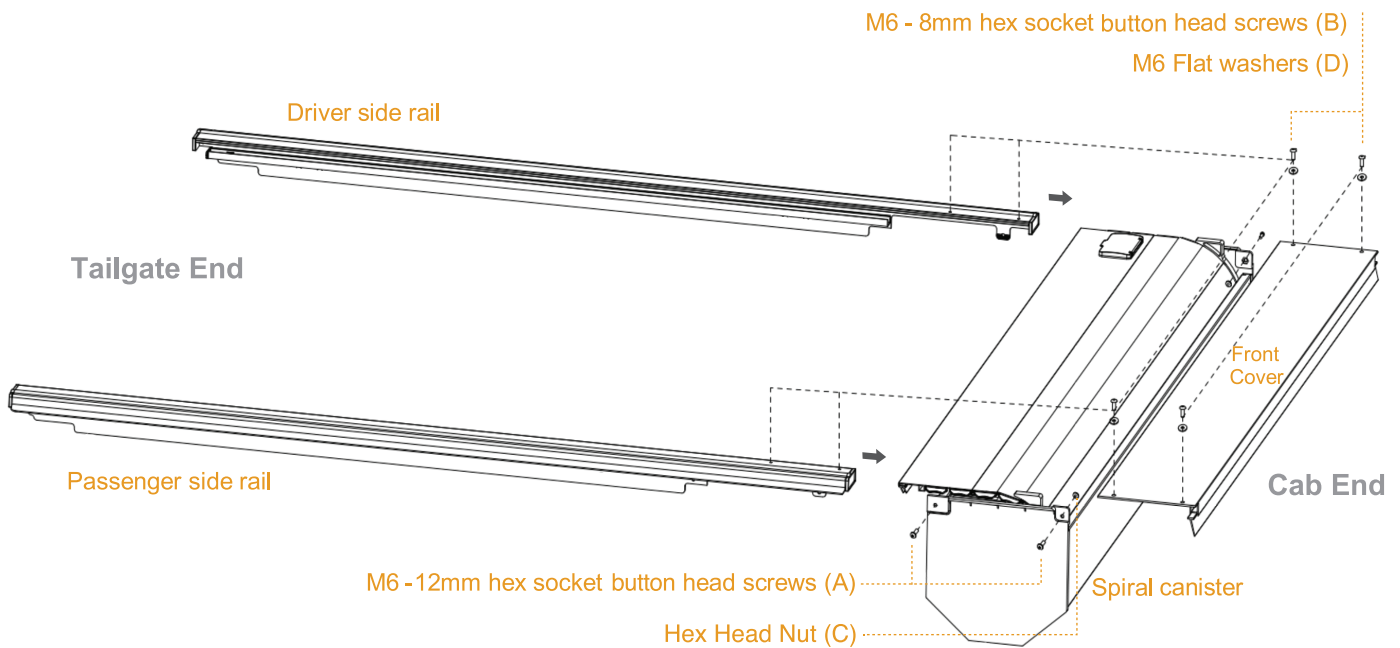

# INSTALLATION PROCEDURE

1. Read installation manual and installation drawings completely before un-boxing and assembling the bed cover.
2. Please save Instructions: Important Warranty and Maintenance information enclosed.
3. Unpack carefully to prevent scratching. Keep boxes and packing materials until installation is complete.
4. See Maintenance page for proper care.

## STEP 1

### Assemble the rails to the spiral canister

<https://shorturl.at/eyJN7>

▶ Watch Step 1 in action



**1a. Disengage cover locks on both sides by pressing release button.**

**1b. Keep the end of cover flat and slide into the rails channel.**

*NOTE: Do not let the cover slats roll back into the canister until rails are installed*

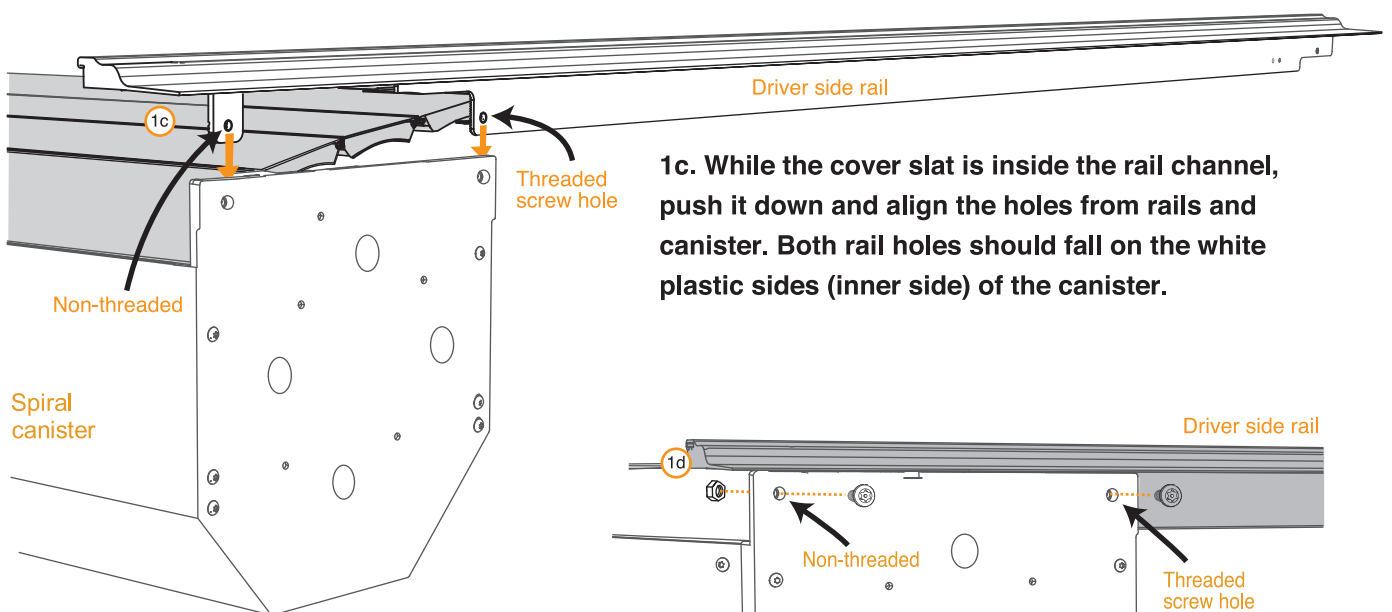
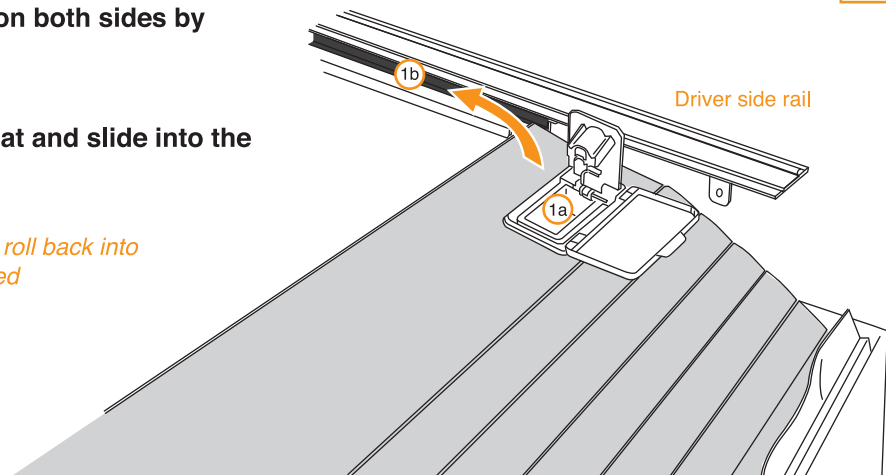

**1c. While the cover slat is inside the rail channel, push it down and align the holes from rails and canister. Both rail holes should fall on the white plastic sides (inner side) of the canister.**

**1d. With the rails in place and the cover inside the rail channel, attach the rails with the 12mm hex screws (A) and hex head nuts (C), for the non-threaded hole, and the 12mm hex screws (A) without the nut for the threaded hole.**

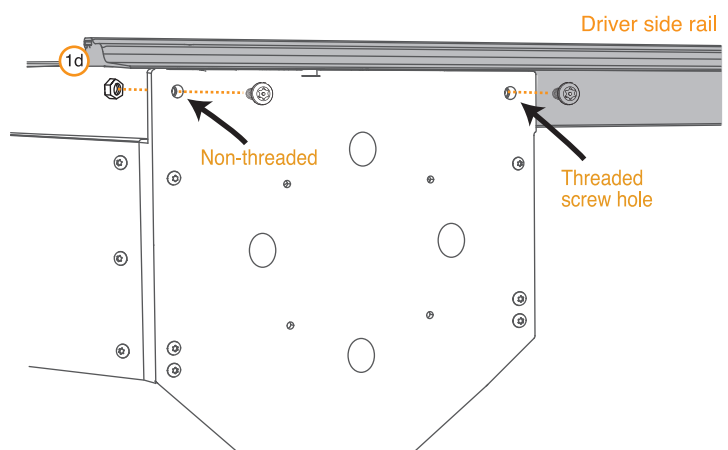



## STEP 2 Install the front cover

2a. Slide the front cover on top of the rails

2b. Use M6 hex wrench (H).

Attach front cover on both rails with M6 - 8mm screws (B) and M6 flat washer (D)

The weather strip faces outward

## STEP 3 Position the cover assembly and the rails

3a. Place the Waterproof Pad (F) to both sides of the front truck bed rail

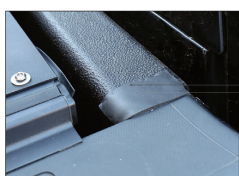

3a

*NOTE: Before installing, some drop-in style bedliners may need to be trimmed in the front cab end corners to allow complete fitment of the cover canister.*

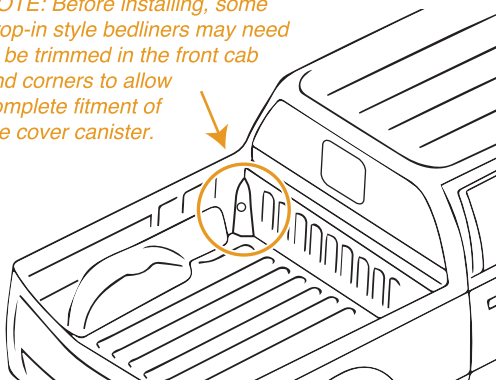

*NOTE: With the cover in place, the front seal lays flat, and must not extend past the bed rail cap.*



Cab

3b. With two people, lift the cover assembly and place it onto the truck bed, starting by placing the canister portion near the bulkhead. The front seal of the cover should be laid flat, not tucked in.

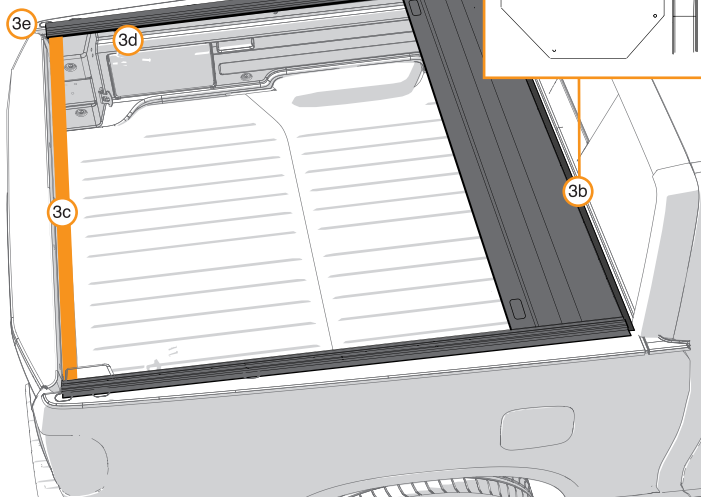

3c. Use the distance bar to adjust that the distance between rails and ensure they are equidistant

*NOTE: Remove the distance bar after all clamps have been tightened*



3d. Remove the bottom screw from each bracket. Insert the smaller piece into both sides of the factory rails

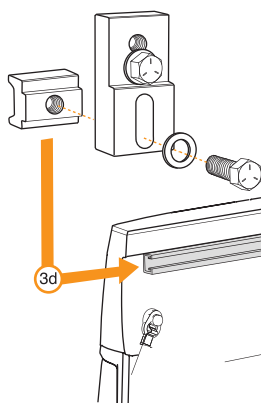

3e. Pull the cover assembly back toward the tailgate, using the plastic pad (M) to ensure 1/8" gap in between the tailgate and rails.

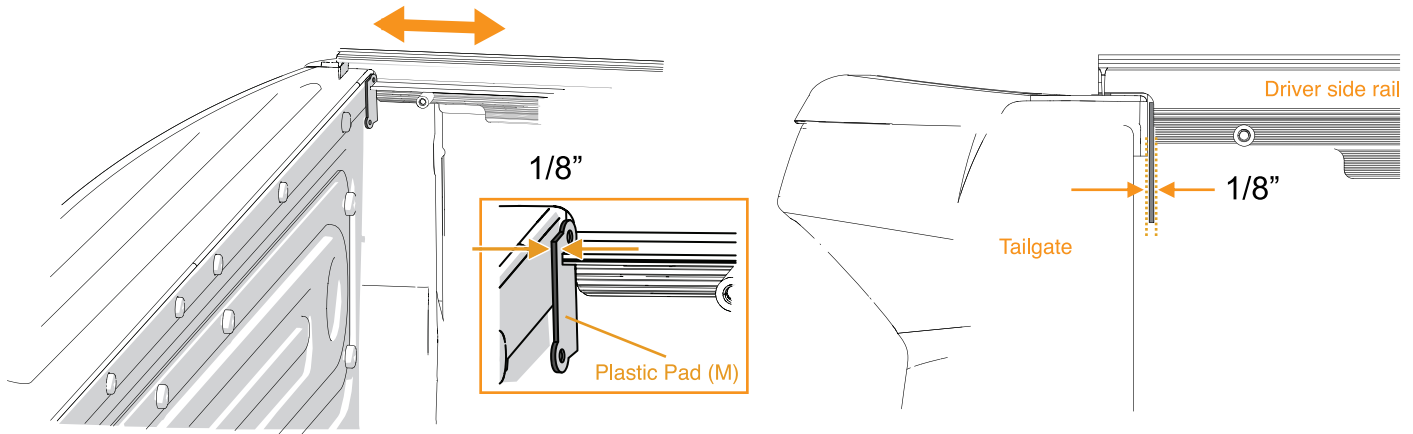

## STEP 4 Install the front and rear clamps

Install the front & rear set of clamps. Using a 9/16" or 1/2" wrench (depending on your clamps), tighten clamps in the way that is explained below.

1. Insert the smaller piece into the factory rail for both of the smaller pieces
2. Insert bigger piece in between the factory rail and the new rail.

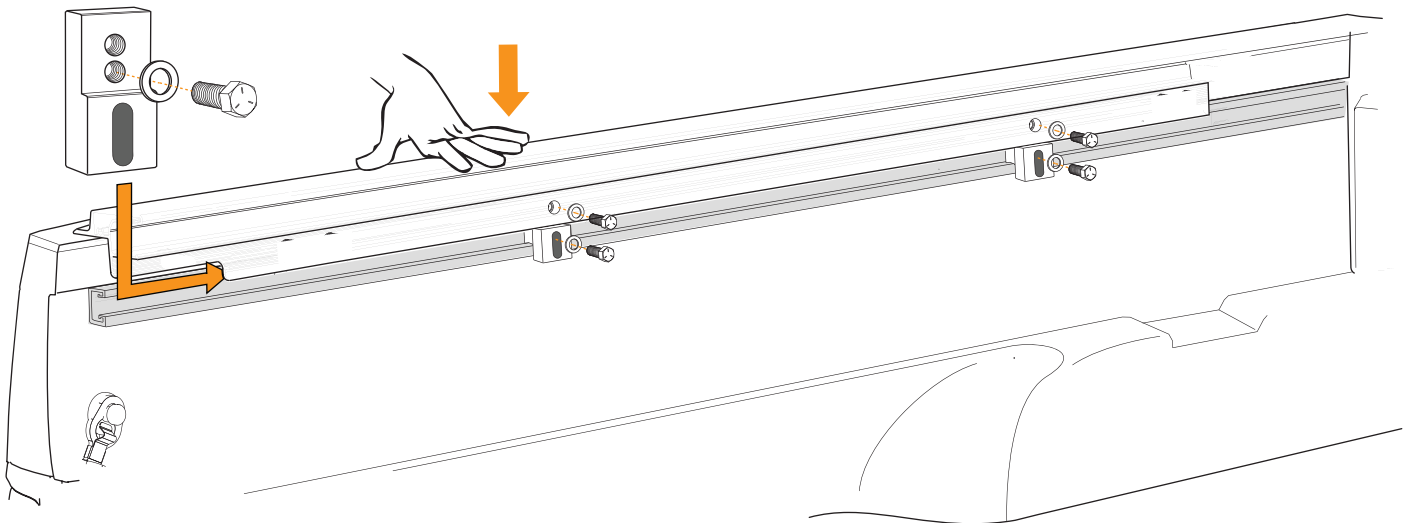

3. The longer screw should go in between the bigger and the smaller piece metal while the shorter screw in between the new rail and the bigger piece as shown. Secure the shorter screw first, then the longer screw.

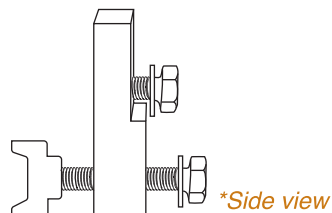
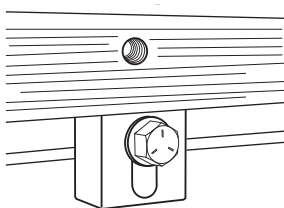

\*Side view

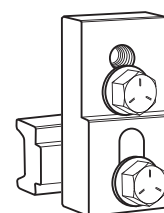

\*Front view

\*Side view of the completed clamp. NOTE: The longer screw should be below the shorter screw

\*Front view of the completed clamp. NOTE: We put shorter screw in the lower hole but you are free to pick the upper hole if it is more convenient

## STEP 5 Checking for proper fit

Measure the distance between the rails at these three locations. Make sure the distance stays the same ( $\pm 1/16''$  as at point A) and parallel.

*NOTE: Rails distance adjustment shown on STEP 3d*

*NOTE: Remove distance bar*

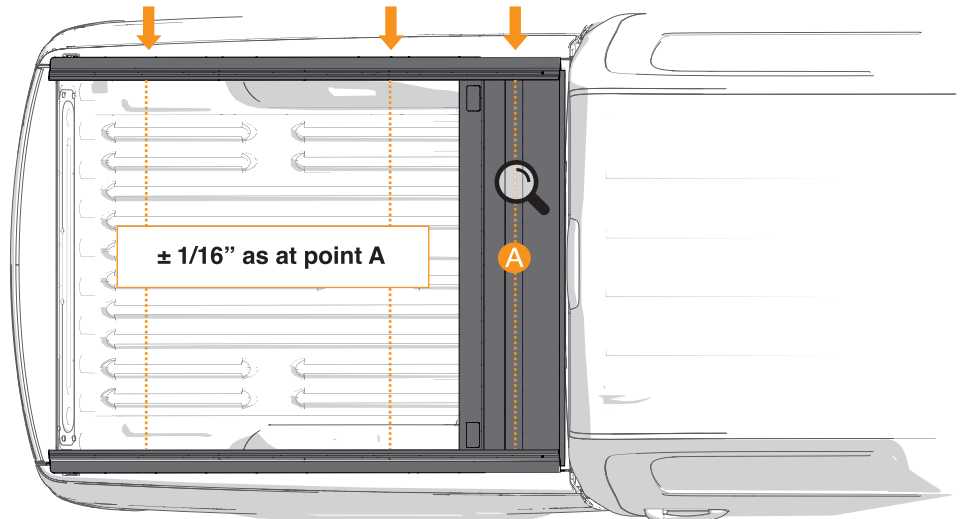

## STEP 6 Assemble and install the drain tubes

6a. Remove the original plastic nut from the box that is embedded in the middle of the long cardboard. Insert the drain tube into the holes and tighten the plastic nut shown as below. Longer tubes for canister. Shorter tubes for rails.

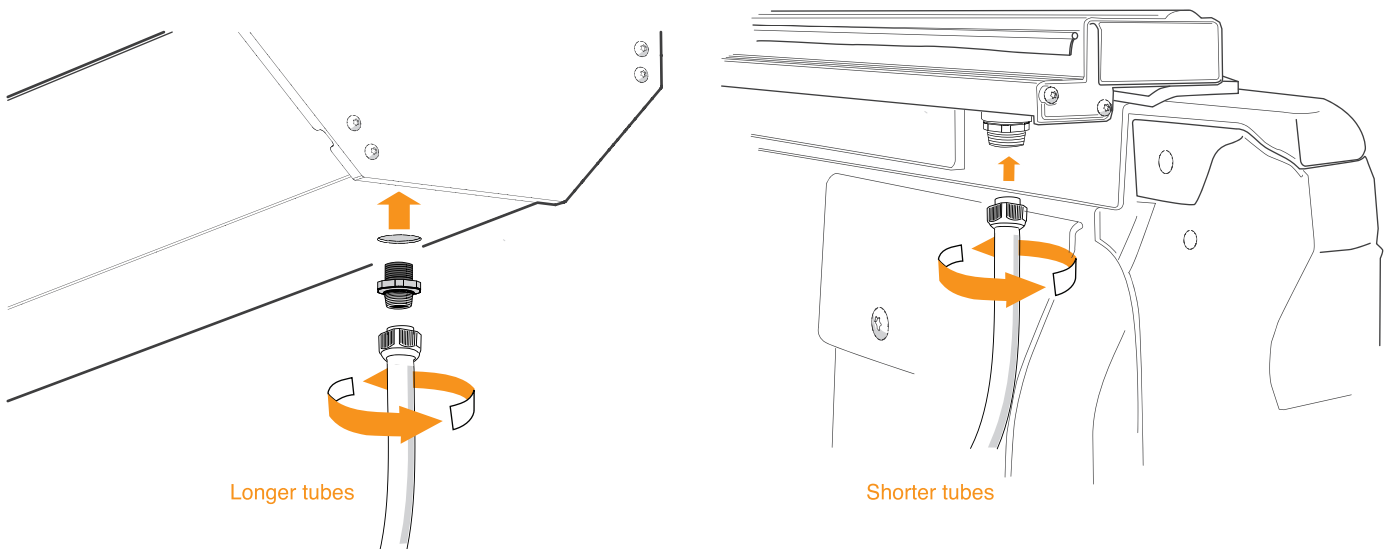

6b. *NOTE: Not all trucks have predrilled holes, need to drill small holes just big enough to plug tubes in that leads out from the bed.*

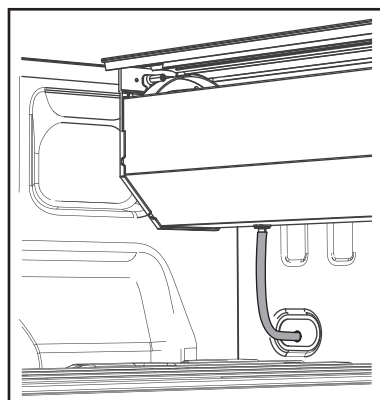

## Final notes

- Open and close the cover to ensure it is rolling without obstruction.
- Be sure that all the clamps and bolts are tighten.
- Clamps/Brackets must be periodically checked for tightness.
- Check rail position and spacing, and adjust accordingly.

*NOTE: On some models, a better fit over the tailgate maybe obtained if the rear of the rails are slightly up or down*

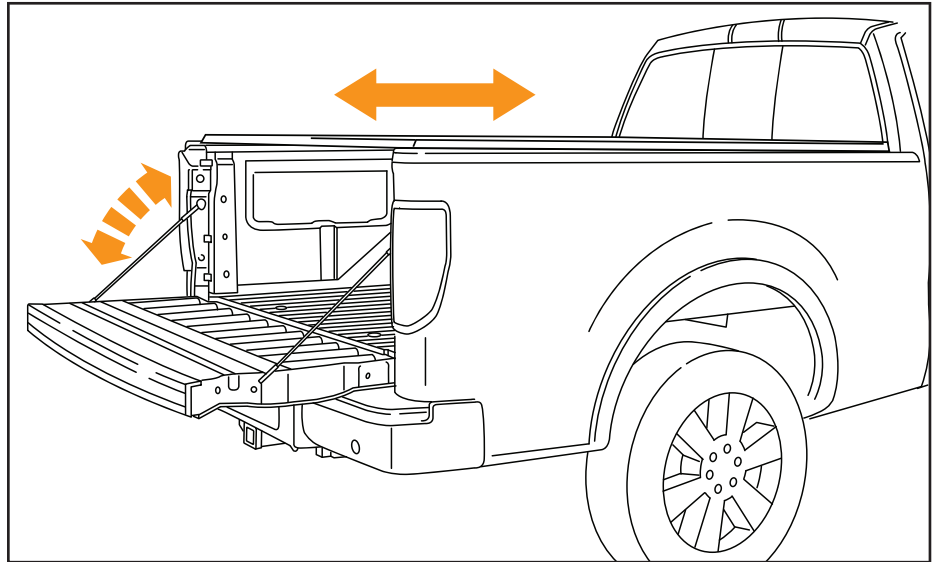

## Maintenance

The retractable cover was designed for ease of operation, low maintenance, and minimal service requirements. To ensure a long, trouble-free life of the roll cover, it is important to follow the instructions below:

- Leaves, dirt, debris, etc. should be removed from the top of the cover if evident before opening.
- Use only mild soap and water to wash the cover. Never use any chemicals, polishes or waxes on any part of roll cover.
- If cover does not roll freely, you may check for obstruction and remove any if found. Silicone spray or grease lubricating oil may be used from time to time to spray into the side rail and canister to help the cover slide & operate more freely





jcwinauto@gmail.com  
ebay@syneticusa.com



<https://jcwinauto.com/>  
<http://syneticusa.com/>



626-360-5034